

# EURUS S8 INSTALLATION INSTRUCTIONS

## Table of Contents

1	Safety Consideration	
1-1	Risk Level Interpretation .....	4
1-2	Safety Precautions .....	5
2	Cautions regarding installation	
2-1	Precautions for installation .....	6
3	Installation	
3-1	EURUS dimensions .....	7
3-1-1	Distance within the treatment room .....	7
3-1-2	EURUS side view .....	9
3-2	Necessary tools and supplied parts .....	12
3-2-1	Necessary tools .....	12
3-2-2	Supplied parts .....	13
3-3	Installation procedure .....	17
3-3-1	Installing the chair .....	17
3-3-2	Installing the cuspidor unit .....	23
3-3-3	Installing the Vac Pac unit .....	27
3-3-4	Installing the doctor unit .....	31
3-3-4-1	Base mount .....	31
3-3-4-2	Cart .....	33
3-3-4-3	Swing mount .....	36
3-3-5	Installing the dental light .....	40
3-3-6	Wiring / Piping .....	43
3-3-6-1	Cuspidor unit type .....	43
3-3-6-2	Vac Pac unit type .....	49
3-3-7	Checking for proper operation .....	55
3-3-8	Setting the lower volume limit of the dental light intensity ..	56
3-3-9	Installing the seat, backrest, and other parts of the chair ...	57
3-3-10	Positioning / Fix .....	61
3-3-11	Attaching the cover .....	62
3-3-12	Adjustment of doctor unit .....	71
3-3-12-1	Adjustment the level of doctor table .....	71
3-3-12-2	Adjustment the rotating friction of the table ..	73
3-3-12-3	Adjustment of balance arm .....	75
3-3-13	Settings for stick switch .....	76



## Table of Contents

3-4	Attaching options .....	77
3-4-1	Monitor bracket .....	77
3-4-2	Panorama-sized viewer/dental viewer .....	80
3-4-3	Intraoral camera bracket .....	84
4	Flow Diagram / Wiring Diagram	
4-1	Flow Diagram .....	90
4-2	Wiring Diagram .....	92

# 1 Safety Consideration

## 1-1 Risk Level Interpretation

### Precautions before use

Make sure to carefully read the Safety Precautions and Operating Precautions and use the product correctly.

These precautions are intended to ensure the safe use of the product and prevent harm or damage to users or other people. According to the magnitude of harm and damage and the degree of urgency, an incident that may be caused by misuse of the product is classified into one of the following categories: CONTRAINDICATION, WARNING, and CAUTION.

All of these categories are important for safety. Always follow the instructions provided.

We assume no responsibility for any accident due to failure to follow the Safety Precautions or Operating Precautions even in the event of harm or damage to users or other persons.

In such case, users or other persons who use the product without observing the Safety Precautions and Operating Precautions are responsible for any harm or damage incurred. The graphical symbols are explained in detail below.

Once you have fully understood this explanation, read the text.

### Classification by degree of harm or damage and urgency

#### CONTRAINDICATION

Use of the product without regard to this indication will create a hazardous condition that may result in death or serious injury.

#### WARNING

Improper handling of the product without regard to this indication will create a hazardous condition that may result in death or serious injury.

#### CAUTION

Improper handling of the product without regard to this indication will create a potentially hazardous condition that may result in moderate or slight injury or property damage.

The following graphical symbols are used to explain your responsibilities for using the product safely:

#### Graphical symbols for prohibited activity



Generally prohibited activity



Disassembly, repair or modification prohibited

#### Graphical symbol for mandatory instructions



Mandatory instructions for ordinary users

# 1 Safety Consideration

## 1-2 Safety Precautions

### CONTRAINDICATION

Installing or transferring the product



#### Precautions regarding installation

Do not install the product near electromagnetic sources such as communication facilities or elevators.

Malfunction of this product may occur in the presence of electromagnetic interference waves.

### WARNING

Installing or transferring the product



#### Precautions for installing the monitor bracket.

To avoid the current leakage, don't pass the power cable and signal cables for the monitor through the chair.

#### Precautions for installation

Make sure to place the product on a firm and flat floor.

Placing the equipment on a non-flat floor may cause it to fall.

To avoid the risk of electric shock, this equipment must only be connected to a supply mains with protective earth.

Failure or electric leak may result in electric shock.

Installation



#### Precautions for operating the chair

Before and during the chair operation, pay close attention to the operation range (seat raising/lowering direction, backrest lowering/raising direction), and ensure that the chair does not contact any body parts, hands or feet, or objects. Body parts, hands or feet, or objects may become caught in the chair, causing injury or damage to peripheral devices.

### CAUTION

Installation



#### Cautions on Installation Work

Metal or mechanical parts of this product may have sharp edges or corners. Be careful to avoid injury to your hands and fingers during installation work.

## 2 Cautions regarding installation

### 2-1 Precautions for installation

1. While carrying the chair, make sure to hold only the designated parts. If not, it may lead to physical injury.
2. Confirm that the fixing bolts are tightened before carrying the chair.
3. Take care not to topple the equipment during transportation.
4. Do not drop, hit, or give a shock to the product.
5. Make sure that the installation position and height of each pipe from the floor is accurate.
6. Make sure to remove dirt in the original line before connecting hoses to the pipes.
7. Securely connect supply/drain hoses.
8. Do not connect a power supply other than the rated voltage.
9. Make sure to connect ground wires.
10. Adjust the level of the chair base plate to avoid any swing of the doctor table and the dental light.
11. When the installation process has been completed, verify that all functions work properly and confirm no water leaks or air leaks before covering the product.
12. Pipe connectors are covered with tubes, bags, and seals to prevent dust contamination. Therefore, do not remove them before the piping connection.

### 3 Installation

#### 3-1 EURUS dimensions

##### 3-1-1 Distance within the treatment room

##### Base mount / Cart

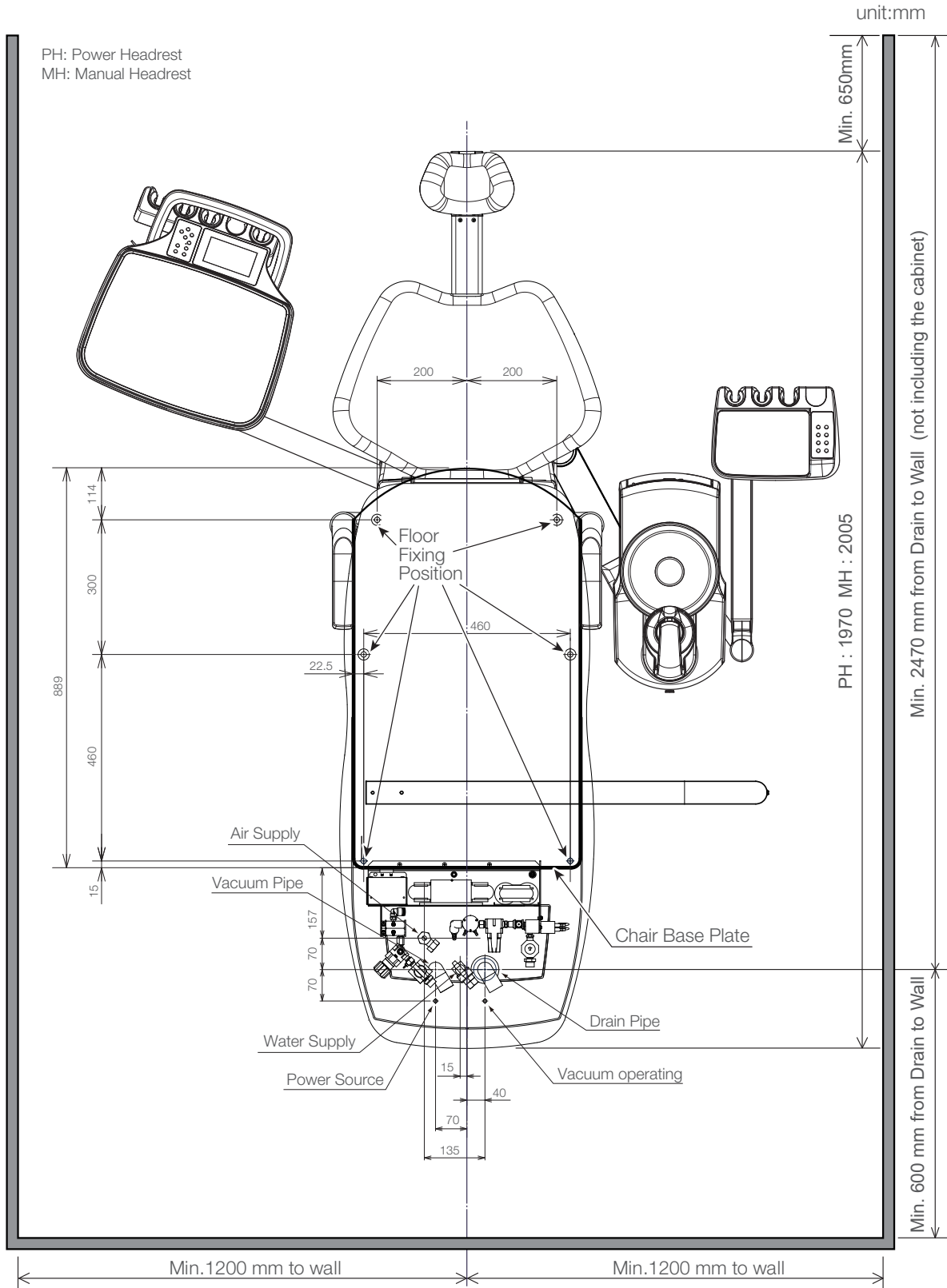

### 3 Installation

#### Swing mount

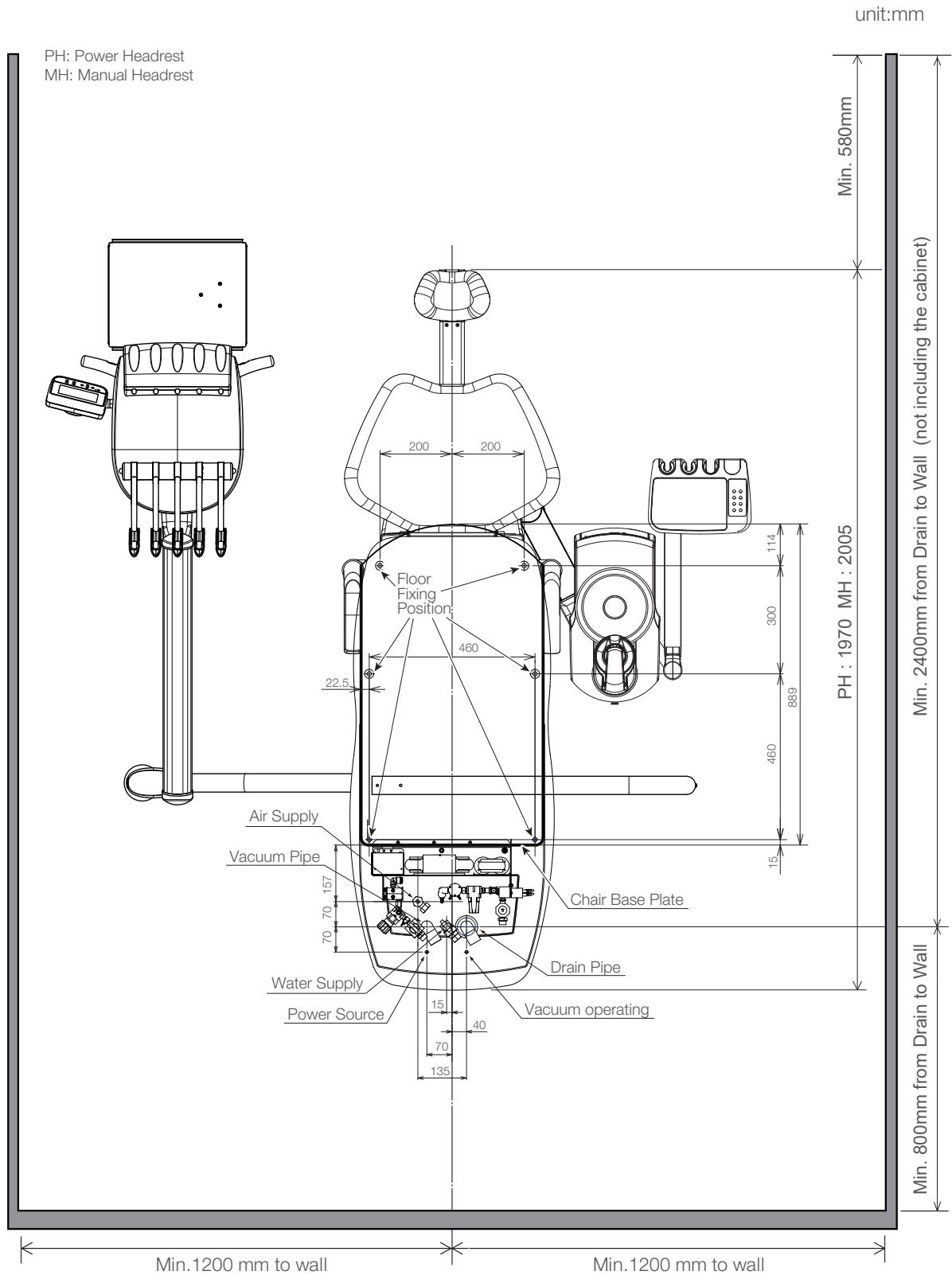

### 3 Installation

#### 3-1-2 EURUS side view

Base mount  
Cuspidor

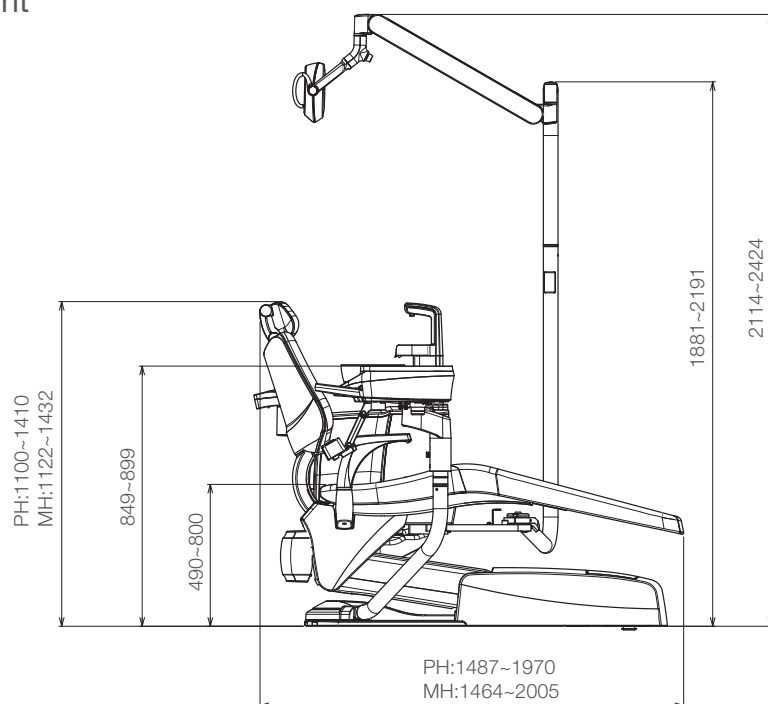

unit:mm

PH: Power Headrest  
MH: Manual Headrest

Base mount  
Vac Pac

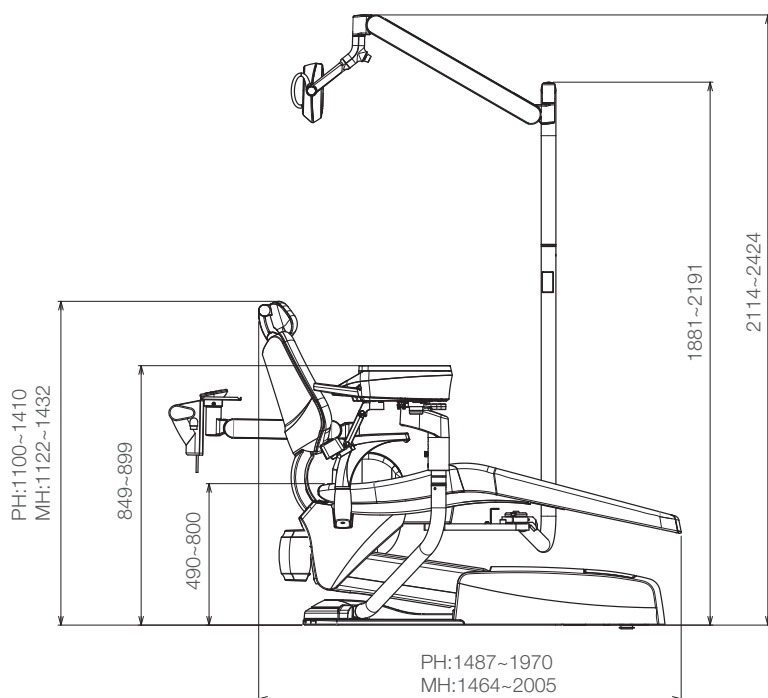

#### Important

Recommended ceiling height  $\geq$  Maximum reach point of the unit  
(see the dimensions) + 100 mm

### 3 Installation

Cart  
Cuspidor

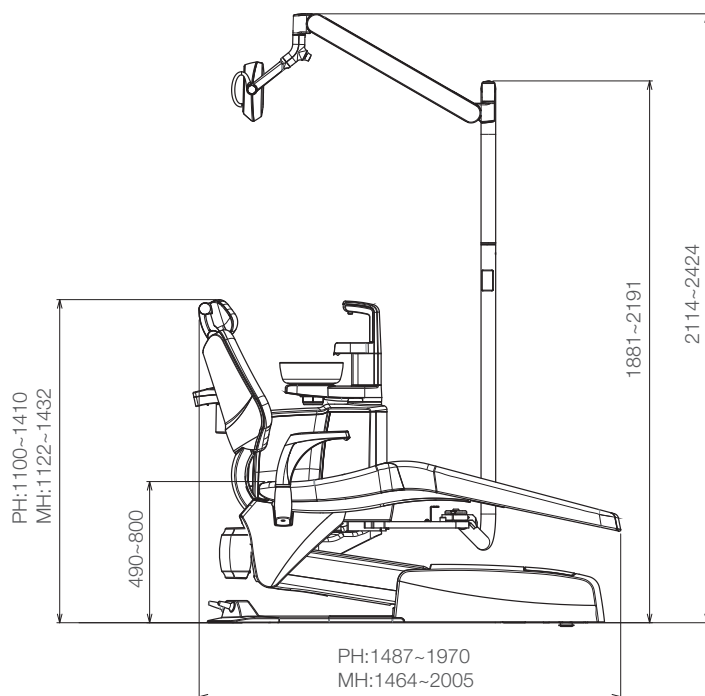

unit:mm

PH: Power Headrest  
MH: Manual Headrest

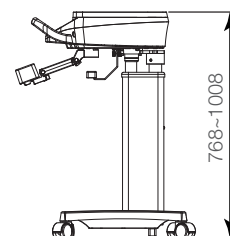

Cart  
Vac Pac

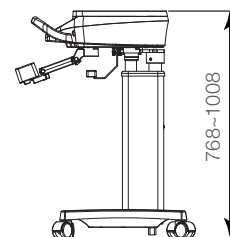
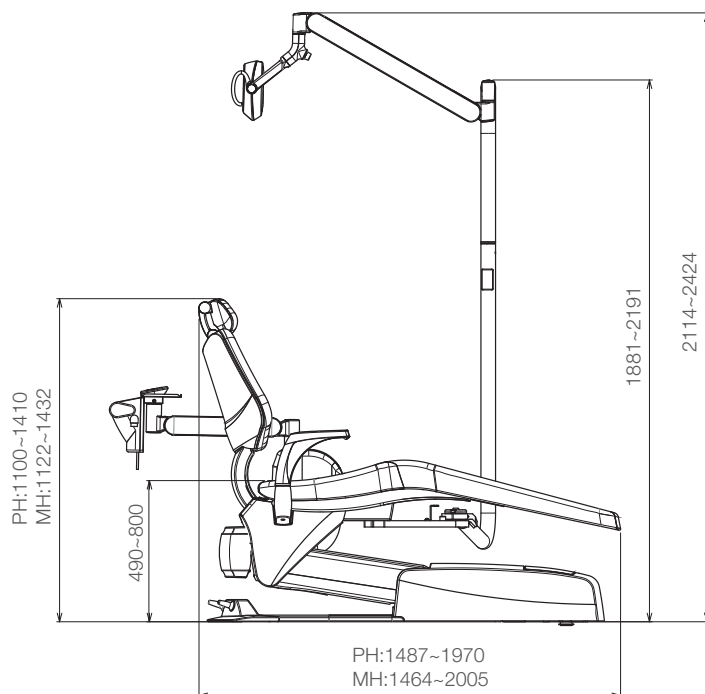

#### Important

Recommended ceiling height  $\geq$  Maximum reach point of the unit  
(see the dimensions) + 100 mm



### 3 Installation

#### Swing mount Cuspidor

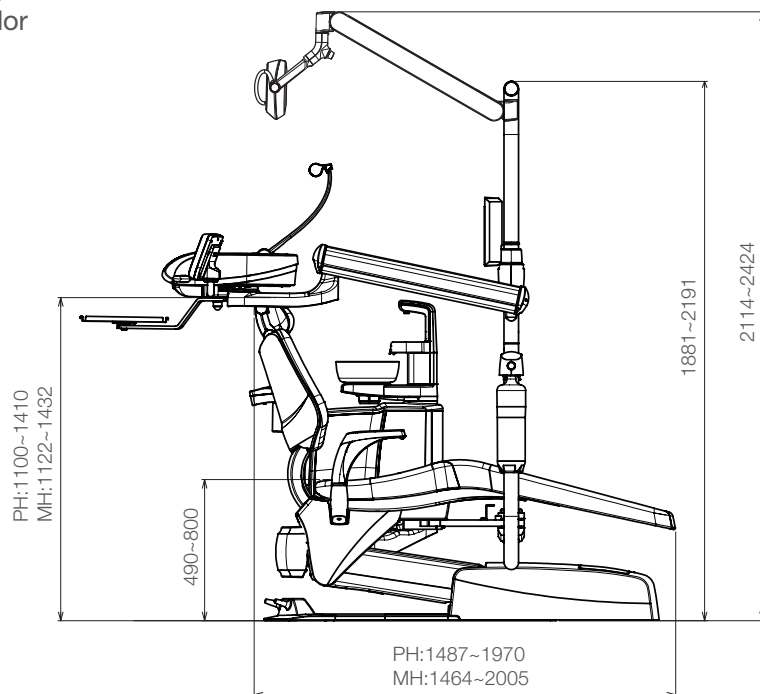

unit:mm

PH: Power Headrest  
MH: Manual Headrest

#### Swing mount Vac Pac

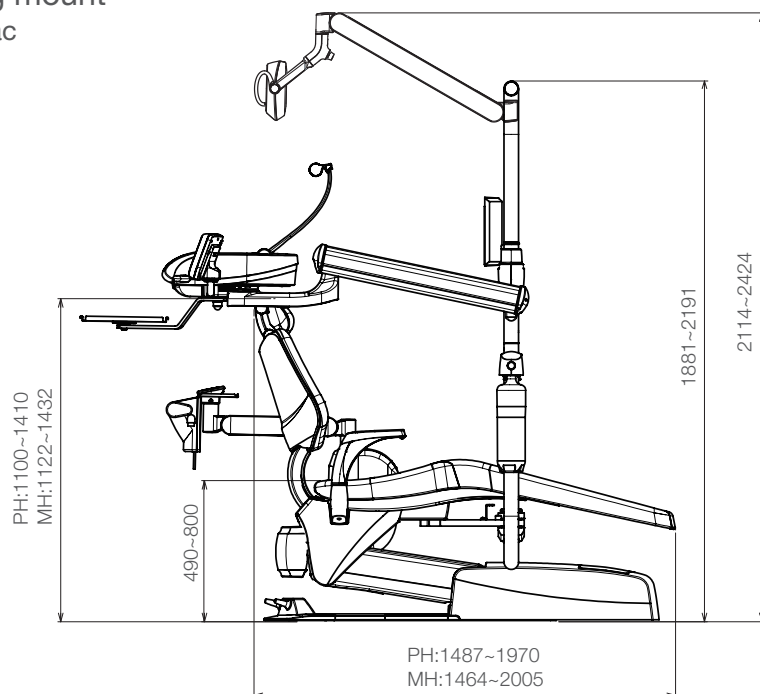

#### Important

Recommended ceiling height  $\geq$  Maximum reach point of the unit  
(see the dimensions) + 100 mm

## 3 Installation

### 3-2 Necessary tools and supplied parts

#### 3-2-1 Necessary tools

The table below shows the necessary tools for the installation of this product.

No.	Tool name	QTY.
1	Phillips screwdriver No. 1-3 (No.2 Total length 300mm or more)	1 for each
2	Flat-blade screwdriver	1
3	Precision screwdriver set (Phillips/flat-blade)	1
4	Monkey wrench (Max. opening width: 29 mm)	1
5	Water pump pliers (Max. gripping capacity: $\phi$ 48.6)	1
6	6-piece double head open end wrench set (5.5-24 mm)	1
7	8-piece hex key wrench set (1.5-8 mm)	1
8	Socket wrench set (socket: 8-22 mm)	1
9	Hook spanner (For outer diameter 52-55 mm)	1
10	Long nose pliers	1
11	Nipper	1
12	Wire stripper	1
13	Crimping tool for insulated terminals	1
14	Level	1

## 3 Installation

### 3-2-2 Supplied parts

The table below shows the supplied parts included in each unit.

#### Chair (unit)

No.	Part name	QTY.	
		Base mount	Cart / Swing mount
1	Hex head flange screw TP-A, M8 × 30, black	6	6
2	Hex socket set screw, flat end, M10 × 10, SUS	6	6
3	Truss screw M4×8, white	4	
4	Hex spacer M4×8	3	3
5	Cap bolt, M6 × 45, black	2	2
6	Spacer, 6 × 30	2	2
7	Spring	2	2
8	Flat washer, M6 × 11.5 × 0.8	2	2
9	Clamp		2
10	Pump cover	1	1
11	Junction cover	1	1
12	Headrest unit	1	1
13	Headrest cover	1	1
14	Backrest cover	1	1
15	Base cover	1	1
16	Base cover lid		2
17	Hose cover	1	
18	Stick switch		1

#### Chair (cover parts)

No.	Part name	QTY.
1	Pan head screw 2P, M4 × 20, plated	6
2	Seat bottom cover (right)	1
3	Seat bottom cover (left)	1
4	Seat	1
5	Backrest	1
6	Headrest	1

### 3 Installation

#### Doctor unit (Base mount / Cart)

No.	Part name	QTY.	
		Base mount	Cart
1	Pan head screw, 3P, M4 × 8, plated		3
2	Pan head screw, 3P, M4 × 20, plated	7	7
3	Pan head screw, 2P, M5 × 25, plated	4	4
4	Hexagon socket countersunk head screw, M8 × 15, black	4	
5	Arm cover	1	
6	Table top	1	1
7	Doctor table tray	1	1
8	Cart hose bracket		1
9	Hex head flange screw TP-A, M8 × 30, black		2

#### Doctor unit (Swing mount)

No.	Part name	QTY.
1	Light mount bracket and doctor swing arm	1
2	Flat washer, M10 × 22 × 1.6, SUS	4
3	Spring washer, M10, SUS	4
4	Cap bolt, M10 × 40, SUS	4
5	Rotating washer	1
6	Pan head screw, 2P, M3 × 8, SUS	4
7	Capbolt, 2P, M5 × 10, SUS	4
8	Operation panel	1
9	Back cover of operation panel	1
10	Rest holder	1
11	Tray holder	1
12	Rod arm	4-5
13	End-cap	1
14	Pan head screw, M4 × 10, SUS	2
15	Bottom cover bracket [Only for cuspidor unit mount type]	1
16	Capbolt, M10 × 16, black [Only for cuspidor unit mount type]	2
17	Spring washer, M10, plated [Only for cuspidor unit mount type]	2
18	Bottom cover [Only for cuspidor unit mount type]	1
19	Truss screw, M5 × 10, whit [Only for cuspidor unit mount type]	3

\* In case selecting the optional panorama-sized viewer/dental viewer/intraoral camera bracket, their parts are also included.

### 3 Installation

#### Cuspidor unit

No.	Part name	QTY.	
		Base mount / Cart	Swing mount
1	Thrust washer	4	4
2	Thrust bearing	2	2
3	Bearing nut	1	1
4	Rubber cap	1	1
5	Hose cover	1	1
6	Hose guide	1	1
7	Assistant silicone mat	1	1
8	Light pole [with the dental light spec. only]	1	1
9	Light swing arm [with the dental light spec. only]	1	1
10	Light mount bracket [with the dental light spec. only]	1	
11	Flat washer, M10 × 22 × 1.6, SUS [with the dental light spec. only]	4	
12	Spring washer, M10, SUS [with the dental light spec. only]	4	
13	Cap bolt, M10 × 40, SUS [with the dental light spec. only]	4	
14	Brake shoe [with the dental light spec. only]	1	1
15	Hex socket set screw, M6 × 6, SUS [with the dental light spec. only]	1	1
16	Junction parts assembly	1	1
17	Connecting elbow	2	2
18	Pan head screw, 2P, M5 × 8, plated	2	2
19	Pan head screw, 2P, M5 × 10, plated	2	2
20	Cuspidor bowl	1	1
21	Drain outlet cover	1	1
22	Strainer	1	1
23	Foot controller (wired or wireless)	1	1

### 3 Installation

#### Vac Pac unit

No.	Part name	QTY.	
		Base mount / Cart	Swing mount
1	Thrust washer	4	4
2	Thrust bearing	2	2
3	Bearing nut	1	1
4	Rubber cap	1	1
5	Hose guide	1	1
6	Assistant silicone mat	1	1
7	Cap bolt, M10 × 16, black	2	2
8	Spring washer, M10, plated	2	2
9	PCB for assistant side	1	1
10	Light pole [with the dental light spec. only]	1	1
11	Light swing arm [with the dental light spec. only]	1	1
12	Light mount bracket [with the dental light spec. only]	1	
13	Flat washer, M10 × 22 × 1.6, SUS [with the dental light spec. only]	4	
14	Spring washer, M10, SUS [with the dental light spec. only]	4	
15	Cap bolt, M10 × 40, SUS [with the dental light spec. only]	4	
16	Brake shoe [with the dental light spec. only]	1	1
17	Hex socket set screw, M6 × 6, SUS [with the dental light spec. only]	1	1
18	PCB cover lid [without the dental light spec. only]	1	
19	Flat washer, M10 × 16 × 1, plated [without the dental light spec. only]	2	
20	Spring washer, M10, plated [without the dental light spec. only]	2	
21	Cap bolt, M10 × 16, black [without the dental light spec. only]	2	
22	Truss screw, M4 × 8, white [without the dental light spec. only]	1	1
23	Junction parts assembly	1	1
24	Connecting elbow	1	1
25	Pan head screw, 2P, M5 × 8, plated	2	2
26	Pan head screw, 2P, M5 × 10, plated	2	2
27	Foot controller (wired or wireless)	1	1

## 3 Installation

### 3-3 Installation procedure

#### 3-3-1 Installing the chair

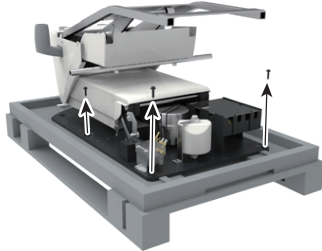

1. Remove the chair from the skid.  
Remove the hex head flange screw TP-A, M6 × 40 (3 pieces) that fix the base and skid.

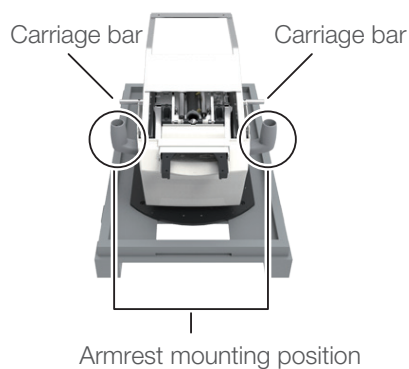

2. Place the chair at the approximate location.  
Hold the carriage bar and the bottom of the armrest mounting position on the right and left sides, and lay down the chair.

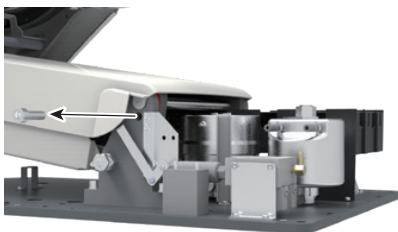

3. Remove the fixing bolts.  
Remove the cap bolt, M10 × 30, plated (1 piece).

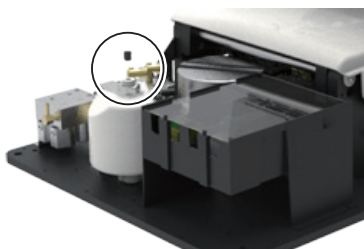

4. Remove the rubber plug of the oil tank.

### 3 Installation

#### Base mount

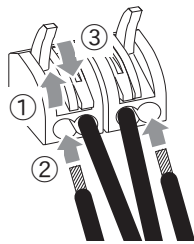

5. Connect the power supply cable to the terminal on the power cable connector of the chair and insert the power plug into a suitable power supply outlet.



6. Connect the chair lift connector (connector 1) to the chair operation line connected to the chair board. The chair will rise when the connector is connected, so disconnect the connector when it rises to the highest position.

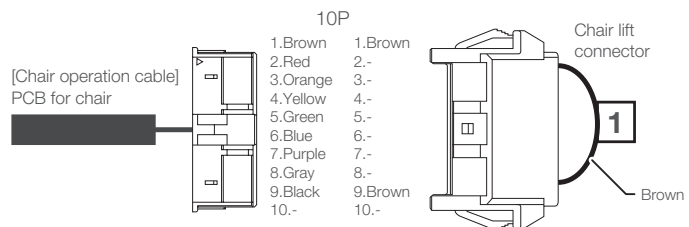

Make sure to insert a connector until it clicks.

When disconnecting a plug, do not pull the cable but hold the connector and pull it.

⇒Go to Procedure 9. [page 20]



### 3 Installation

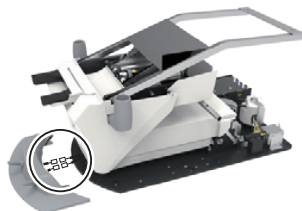

#### Cart / Swing mount

#### 5. Attach the connector for the stick switch.

Attach the connector to the one that starts with same number.

##### For the power headrest :

[Stick switch for manual operation cable]

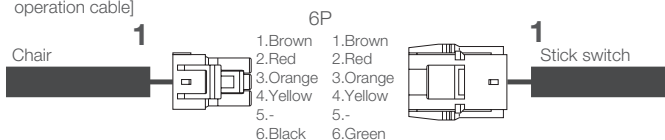

[Stick switch for automatic operation cable]

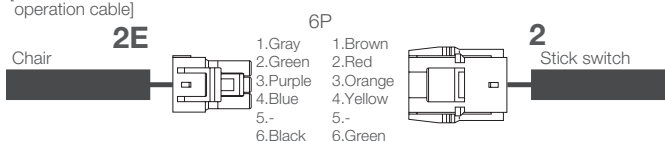

[Stick switch for headrest cable]

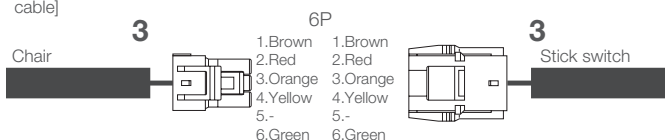

##### For the manual headrest :

[Stick switch for manual operation cable]



[Stick switch for automatic operation cable]



Make sure to insert a connector until it clicks.

When disconnecting a plug, do not pull the cable but hold the connector and pull it.

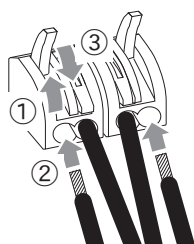

#### 6. Connect the power supply cable to the terminal on the power cable connector of the chair and insert the power plug into a suitable power supply outlet.

### 3 Installation



7. Tilt the stick switch for the chair manual operation up to lift up the chair to its highest position.

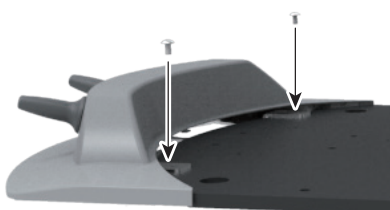

8. Attach the stick switch.

Insert the connected connector into the switch, and remove the pan head screws, 2P, M5 × 10, plated (2 pieces) set at the connecting points and fix the switch with them.



9. Remove the carriage bar.

Remove the cap bolts M10 × 30, plated (2 pieces).

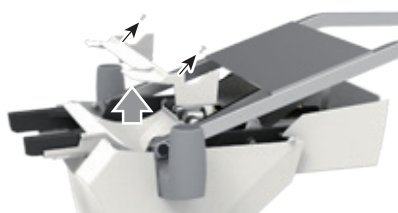

10. Remove the flange cover top.

Remove the pan head screws 2P, M4 × 10, plated (2 pieces).

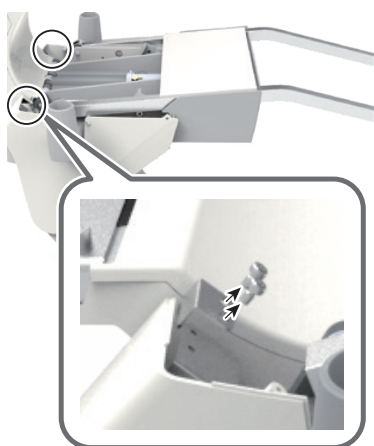

11. Remove the flange cover spacer (1 piece each on right and left).

Remove the pan head screws 2P, M5 × 10, plated (2 pieces each on right and left).

If the flange cover bottom is removed without first removing the flange cover spacer, the hook of the flange cover bottom may be damaged.

### 3 Installation

#### Base mount / Cart

##### With the dental light

12. Temporarily fasten the items shown in the figure to the underside of the chair. (2 places)

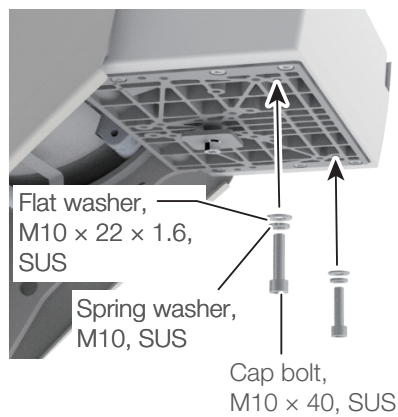

13. Hook the notch in the light mount bracket on the bolt temporarily fastened in Procedure 12 and push it all the way in.

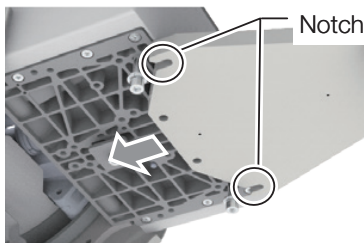

14. Fix it with the items shown in the figure (2 places) and the 2 bolts that were temporarily fastened in Procedure 12.

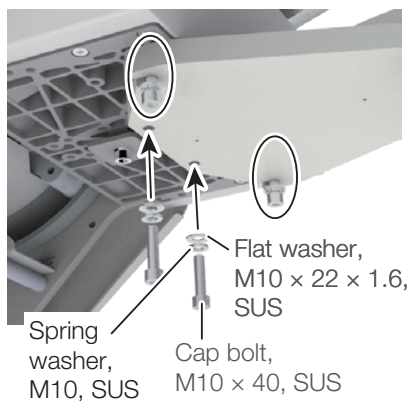

##### Without the dental light

##### (Only for Vac Pac unit mount type)

12. Attach the PCB cover lid to the underside of the chair.

Fix the PCB cover lid with the items shown in the figure. (2 places)

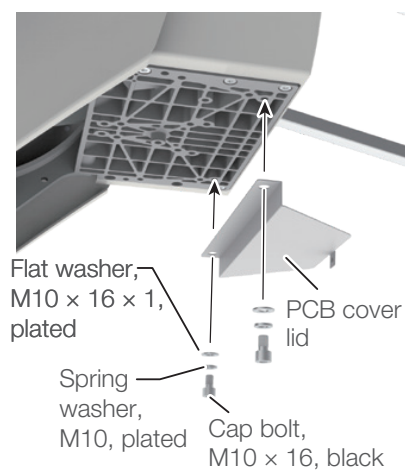

### 3 Installation

#### Swing mount

12. Attach the light mount bracket and doctor swing arm to the chair

(1) Temporarily fasten the items shown in the figure to the underside of the chair. (2 places)

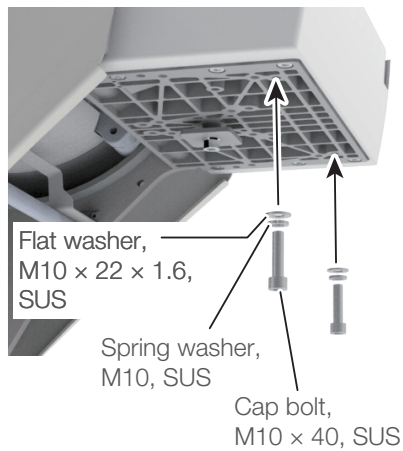

(2) Hook the notch in the light mount bracket on the bolt temporarily fastened in Procedure (1) and push it all the way in.

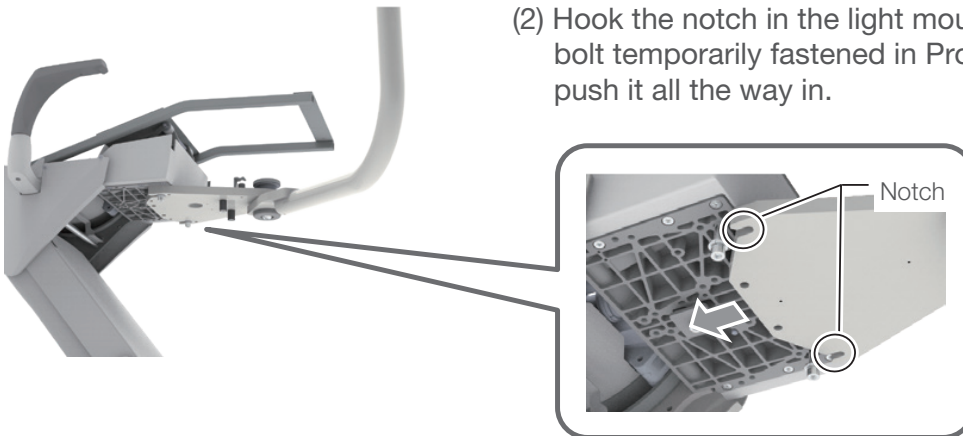

(3) Fix it with the items shown in the figure (2 places) and the 2 bolts that were temporarily fastened in Procedure (1).

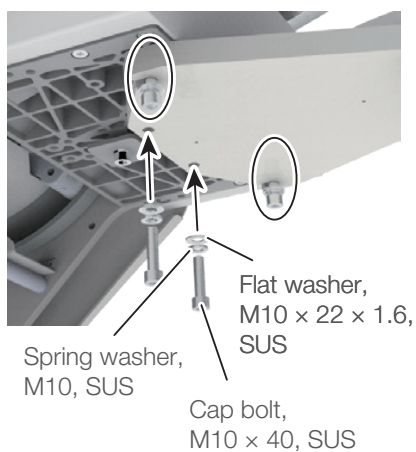

## 3 Installation

### 3-3-2 Installing the cuspidor unit

1. Remove the Knurled screw, M4 × 8, plated (1 piece each on right and left).



2. Pull the side panel (rear) backward to remove it (both right and left).

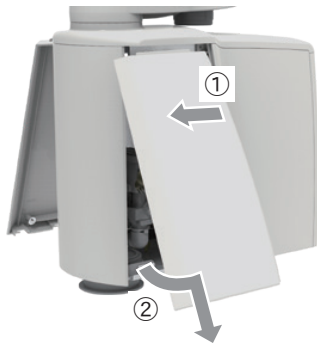

3. Pull the side panel (front) backward to remove it (both right and left).  
Remove the pan head screw, 3P, M4 × 10, SUS (1 piece each on right and left).

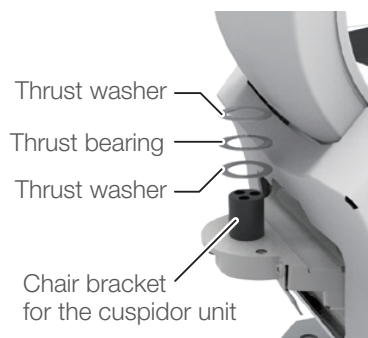
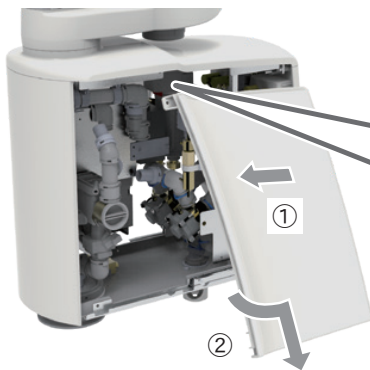

4. Set the thrust washer, thrust bearing and the thrust washer on the chair bracket for the cuspidor unit in the above order.

### 3 Installation

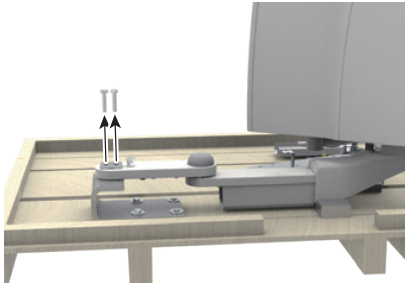

5. Remove the cuspidor unit from the skid.  
Remove the button bolts, M10 × 30, SUS (2 pieces).

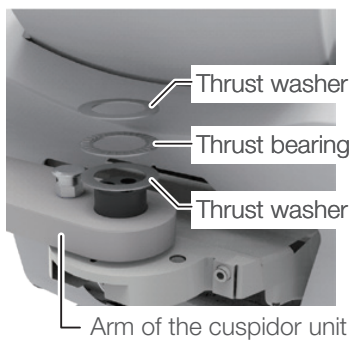

6. Attach the cuspidor unit to the bracket of the chair.  
(1) Set the arm hole of the cuspidor unit to the chair bracket for the cuspidor unit. Then set the thrust washer, bearing washer and thrust washer in the above order.

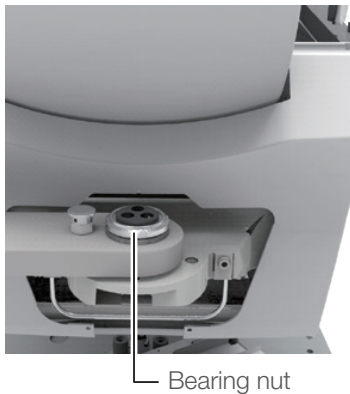

- (2) Fix the cuspidor unit with the bearing nut.  
Tighten the bearing nut with the hook spanner (for outer diameter 52-55 mm) securely.

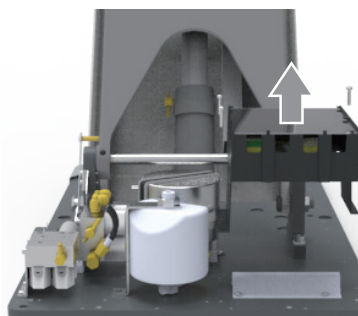

7. Remove the PCB box.  
Remove the pan head screws, 3P, M5 × 12, plated (3 pieces).  
Make a space under the removed PCB box to pass the piping easily.

### 3 Installation

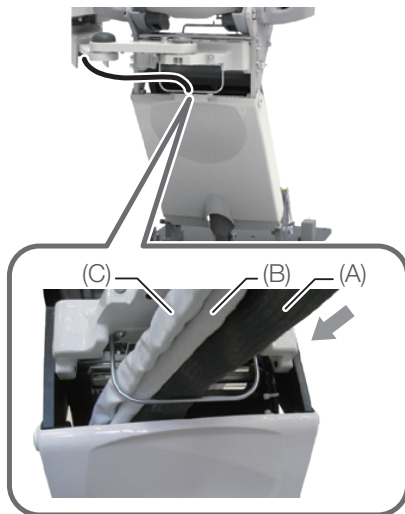

(A) : Hose for drain / vacuum  
(B) : Cable  
(C) : Tube for water / air

8. Pass the piping of the cuspidor unit from the rear to the front bottom of the chair.

Pass the (A) first, and then the (B) and (C).

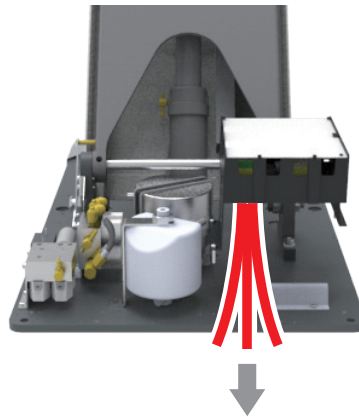

9. Fix the hose for drain / vacuum of piping (A) with cable tie.

Piping with drain hose down and vacuum hose (with green tape) up.

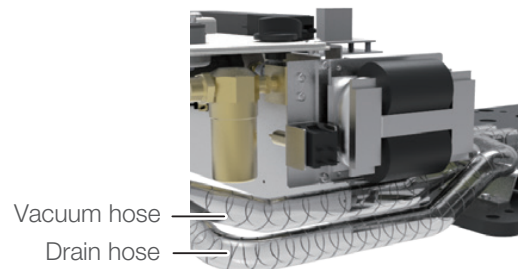
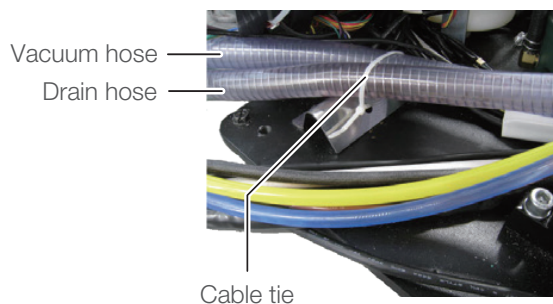

Pipe the drain hose down.  
If you pipe it up, the drainage flow will be impaired.

Base mount / Cart

10. Attach the PCB box reversing Procedure 7.

11. Attach the junction unit to the chair.

Fix the junction unit with pan head screws, 2P, M5 × 10, plated (2 pieces).

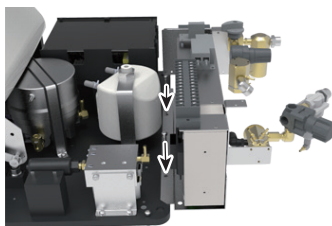

Swing mount

⇒Go to Procedure 12. [page 26]



### 3 Installation

#### 12. Attach the hose cover.

Remove the truss screws, M5 × 10, white (4 pieces) set at the connecting points and fix the hose cover with them.

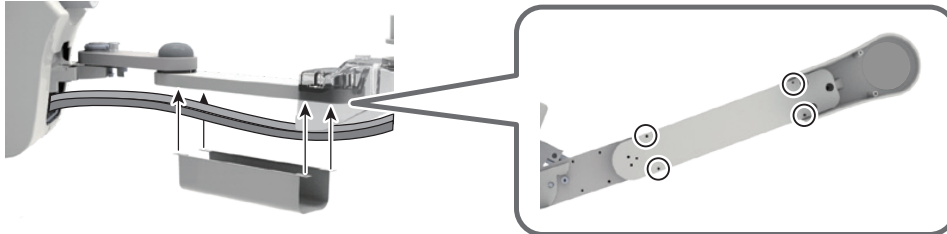

#### 13. Attach the hose guide.

Remove the truss screws, M5 × 10, white (4 pieces) set at the connecting points and fix the hose guide with them.

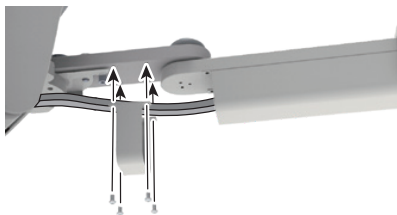

#### 14. Ratchet type assistant unit specification

Remove the cap bolt, 2P, M5 × 10, SUS.

For the standard type

⇒Go to Procedure 15.



#### 15. Attach the arm cover.

Remove the pan head screws, M4 × 40, plated (2 pieces) from the back side of the arm cover, and fix the arm cover by using the removed screws.

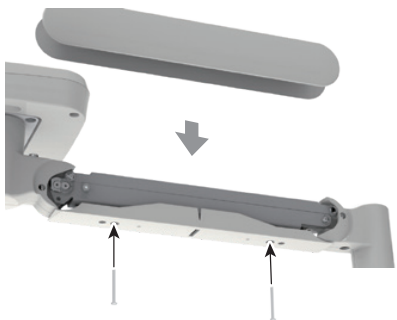



## 3 Installation

### 3-3-3 Installing the Vac Pac unit

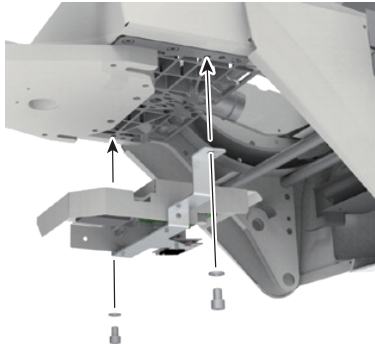

1. Fix the PCB for assistant side to the bottom of the seat and pass the cable from the back of the chair. Fix it with cap bolts, M10 × 16, black (2 pieces) and spring washers, M10, plated (2 pieces).

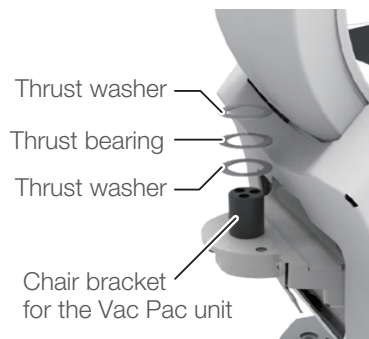

2. Set the thrust washer, thrust bearing and the thrust washer on the chair bracket for the Vac Pac unit in the above order.

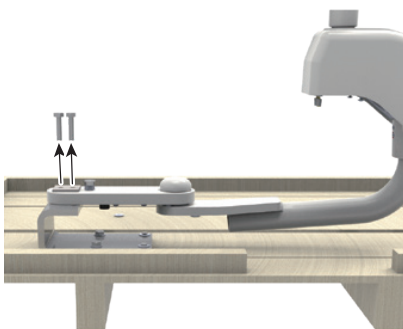

3. Remove the Vac Pac unit from the skid.  
Remove the cap bolts, M10 × 30, SUS (2 pieces).

To lift the VacPac unit, be sure to hold the places shown below. Holding the other places may cause the bottom part fallen and might cause injury.

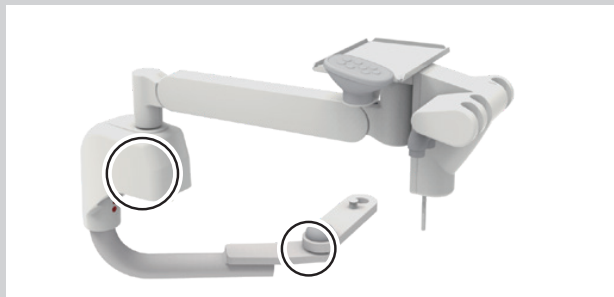

### 3 Installation

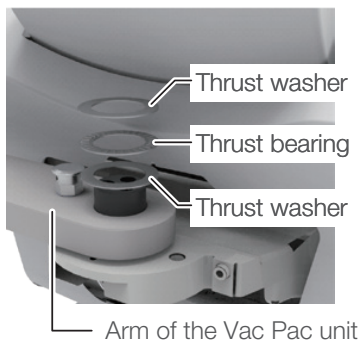

4. Attach the Vac Pac unit to the bracket of the chair.
  - (1) Set the arm hole of the Vac Pac unit to the chair bracket for the Vac Pac unit. Then set the thrust washer, bearing washer and thrust washer in the above order.

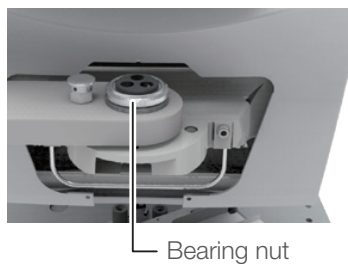

- (2) Fix the Vac Pac unit with the bearing nut. Tighten the bearing nut with the hook spanner (for outer diameter 52-55 mm) securely.

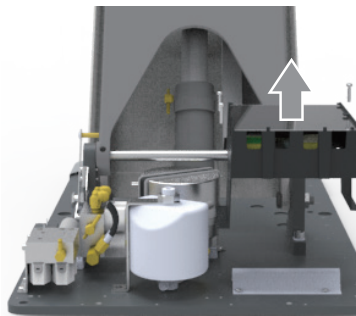

5. Remove the PCB box of the junction unit. Remove the pan head screws, 3P, M5 × 12, plated (3 pieces). Make a space under the removed PCB box to pass the piping easily.

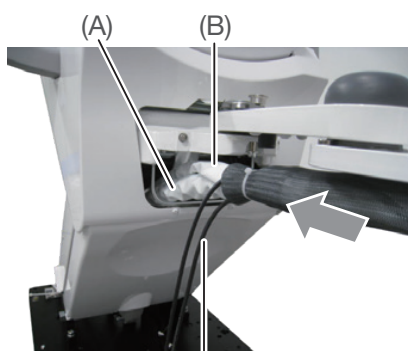

Leave the cable from the Vac Pac unit behind.

6. Pass the tubings from the Vac Pac unit and the cables from the PCB for assistant side to the front bottom of the chair in order of (A), (B)
  - (A) : Cable from the PCB for assistant side
  - (B) : Tubing from the Vac Pac unit.

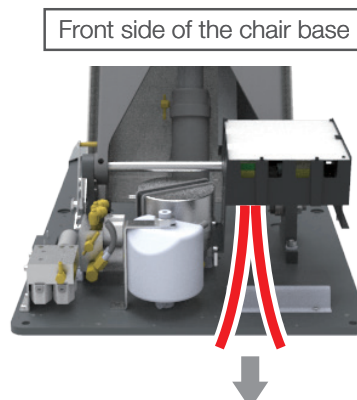

### 3 Installation

7. Fix the hose for vacuum of piping (B) with cable tie.

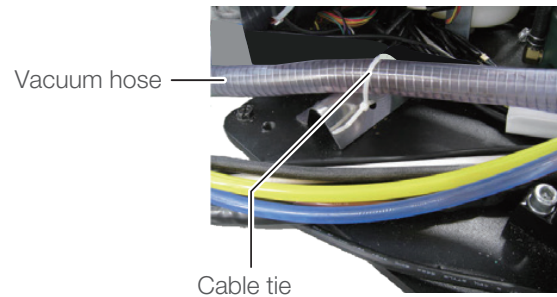

Base mount / Cart

8. Attach the PCB box reversing Procedure 5.

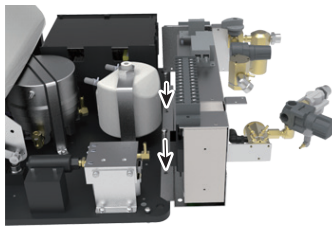

9. Attach the junction unit to the chair.

Fix the junction unit with pan head screws, 2P, M5 × 10, plated (2 pieces).

Swing mount

⇒Go to Procedure 10.



10. Pass the cable from the Vac Pac unit toward the PCB for assistant side.

### 3 Installation

11. Connect the cable to the PCB for the assistant side.

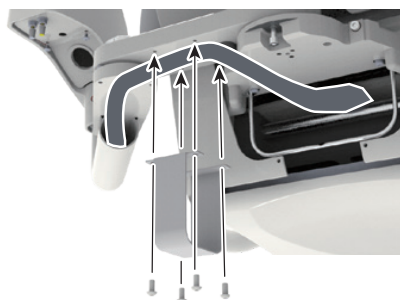
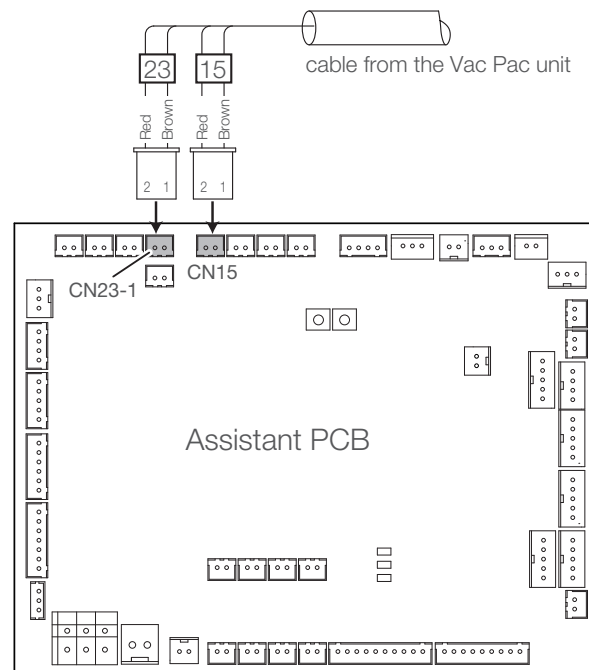

12. Attach the hose guide.

Remove the truss screws, M5 × 10, white (4 pieces) set at the connecting points and fix the hose guide with them.



13. Ratchet type assistant unit specification

Remove the cap bolt, 2P, M5 × 10, SUS.

For the standard type

⇒Go to Procedure 14.

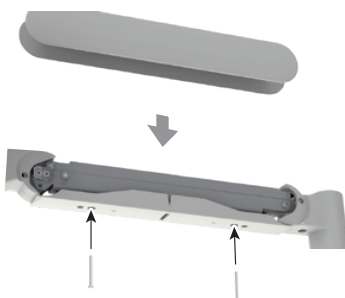

14. Attach the arm cover.

Remove the pan head screws, M4 × 40, plated (2 pieces) from the back side of the arm cover, and fix the arm cover by using the removed screws.

### 3 Installation

#### 3-3-4 Installing the doctor unit

##### 3-3-4-1 Base mount

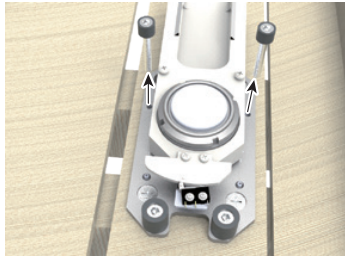

1. Remove the doctor unit from the skid.  
(1) Remove the cap bolt, M6 × 10, plated (2 pieces).

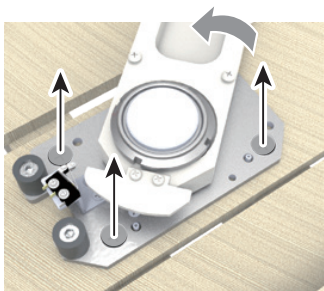

- (2) Rotate the arm in the direction of the arrow.
- (3) Remove the wood screws (3 pieces).

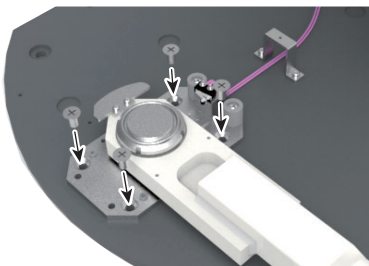

2. Attach the arm of the doctor unit to the base.  
Temporarily fasten with hexagon socket countersunk head screw, M8 x 15, black (4 pieces).

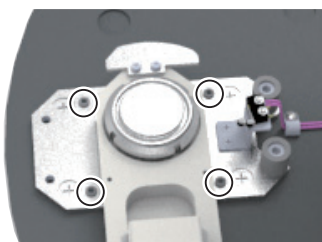

3. Adjustment the level of doctor table.  
Use the hexagon socket set screws, M8 x 8, black (4 pieces).  
After adjustments, tighten the screws in Procedure 2 and fix the arm.

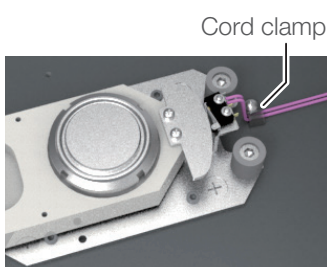

4. Remove the cord clamp, pinch the lead wire, and then attach the cord clamp to its original position.

### 3 Installation

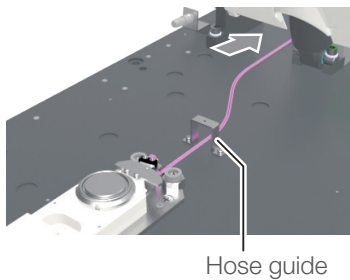

5. Run the lead wire under the hose guide and then through the front of the chair.

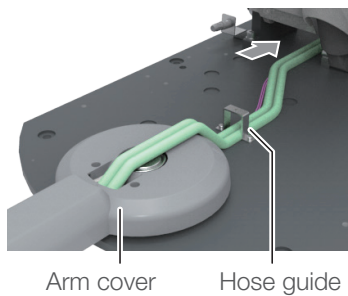

6. Run the pipe of the doctor unit through the arm cover, under the hose guide, and to the front of the chair.

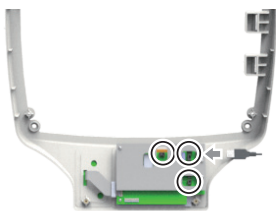

7. Attach the lead cable connectors of the doctor table (3 pieces) and USB connector to the table top.

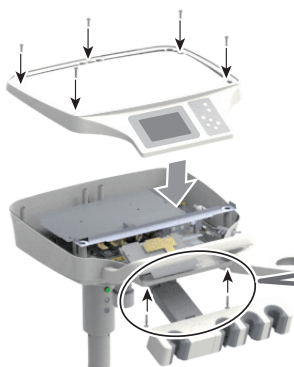

8. Attach the table top.

Fix the table top with pan head screws, 3P, M4 × 20, plated (7 pieces).

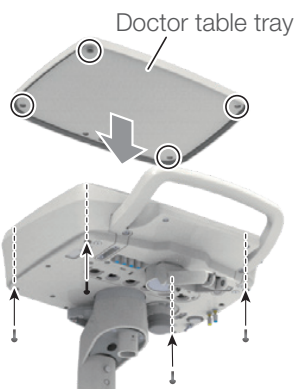
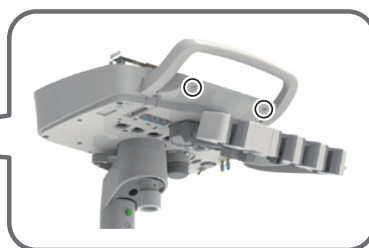

9. Fix the doctor table tray.

Fix the doctor table with Pan head screws, 2P, M5 × 25, plated (4 pieces).

### 3 Installation

#### 3-3-4-2 Cart

For standard specifications

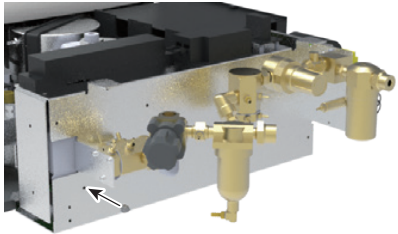

1. Fix the pan head screw 3P, M4 x 8, plated (1 piece) to the junction unit temporarily.

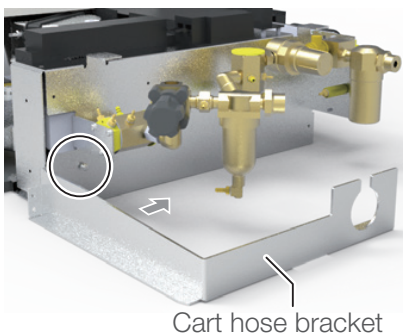

2. Slide the cart hose bracket in the direction of the arrow, and engage it with the temporarily-fixing screw.

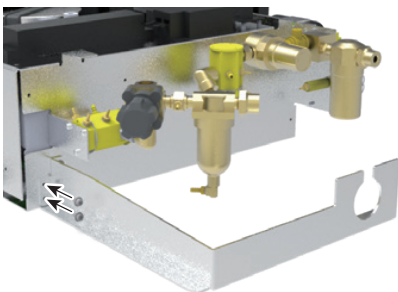

3. Fix the cart hose bracket with the pan head screws 3P, M4 x 8, plated (2 pieces) and the screw fixed temporarily in the Procedure 1.

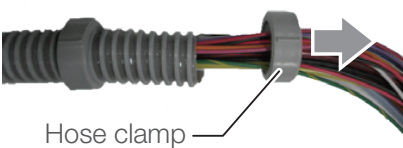

4. Among the 2 hose clamps provided on the cart hose, remove the one located on the tip of the cart hose.

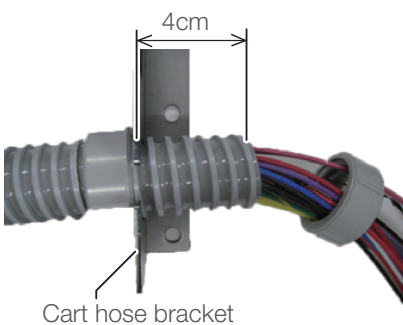

5. Pass the wiring and tubing of the cart hose through the cart hose bracket.



### 3 Installation

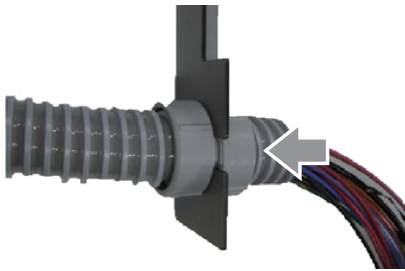

6. Pass the cart hose through the cart hose bracket, and fix the hose clamp temporarily-detached in the Procedure 4.

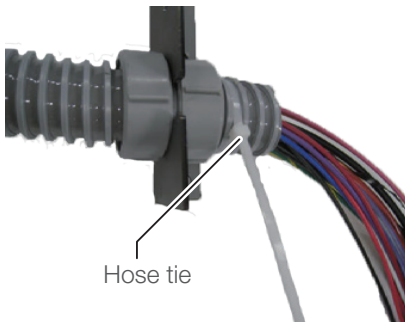

7. Fix the cart hose with the hose tie in contact with the hose clamp.

The hose tie is used to prevent the hose clamp from loosening. Make sure to fix the hose tie.

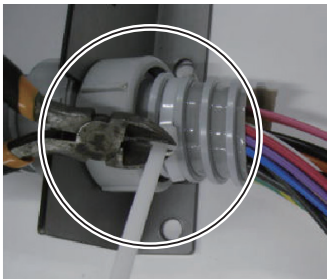

8. Cut the excess part of the hose tie.

When cutting, be careful not to damage the cart hose and hose clamp.

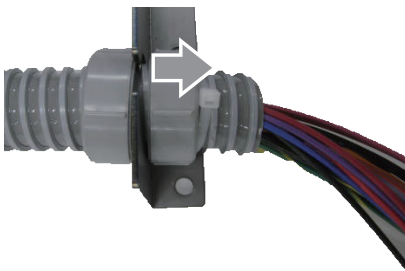

9. Turn the hose clamp until it comes into contact with the fixed hose tie and no longer rotates.

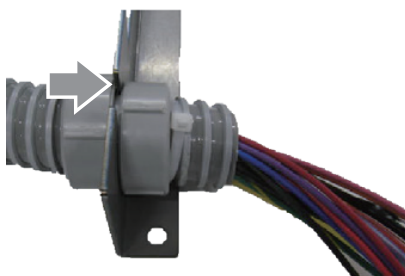

10. Turn the other hose clamp to securely tighten it against the cart hose bracket to fix it.



### 3 Installation



11. Attach the lead cable connectors of the doctor table (3 pieces) and USB connector to the table top.

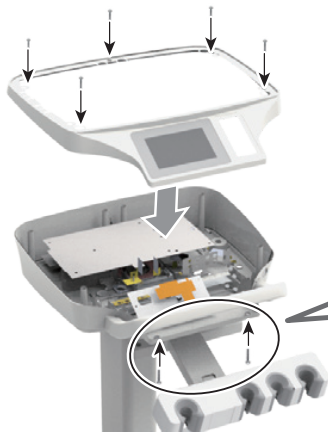

12. Attach the table top.

Fix the table top with pan head screws, 3P, M4 × 20, plated (7 pieces).

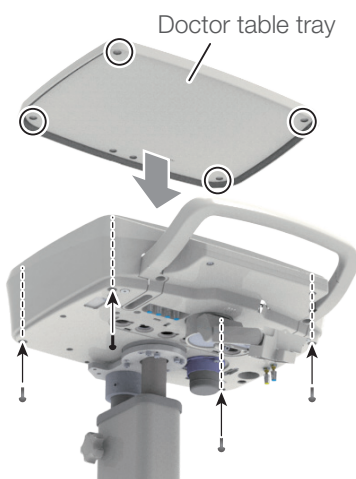
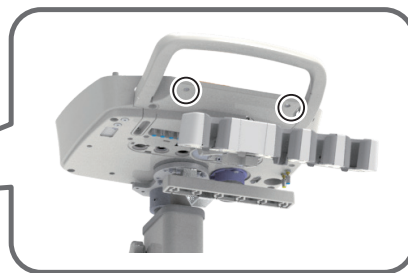

13. Fix the doctor table tray.

Fix the doctor table with Pan head screws, 2P, M5 × 25, plated (4 pieces).

For bypass specifications

Pass the bypass wire under the floor and install Procedure 11 to 13 above.

### 3 Installation

#### 3-3-4-3 Swing mount

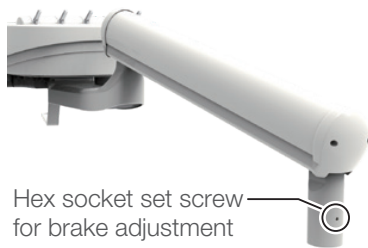

1. Loosen the hex socket set screw shown in the figure and remove the balance arm ASSY from the skid.



2. Pass the Rotating washer through the doctor swing arm.



3. Insert the balance arm to the doctor swing arm.

4. Slide the upper cover on the balance arm and remove it



5. Pass the wiring and tubing of the doctor unit through the doctor swing arm.  
Pass the wiring first, then the tubing.

6. Lift up the chair to its highest position.

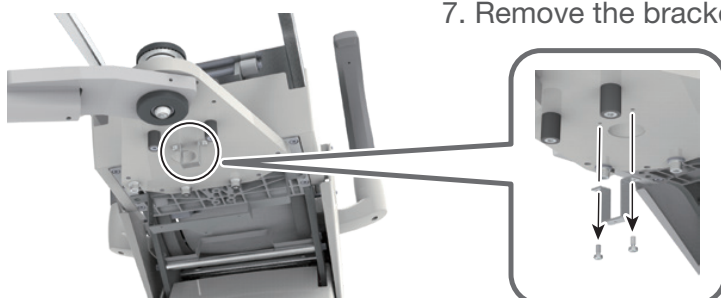

7. Remove the bracket that is pointed in the figure.

### 3 Installation



#### 8. For cuspidor unit mount type

- (1) Pass the wiring and tubing in the step 5 through the chair to the junction box

For clean water system specifications, bundle the water tank tubing and pass it together.

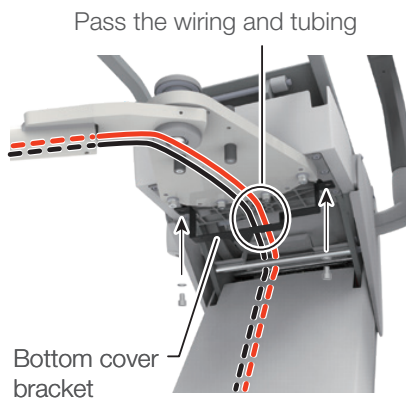

Pass the wiring and tubing

- (2) Attach the bottom cover bracket under the chair with the below screws

Capbolt, M10 x 16, black (2 pieces)

Spring washer, M10, plated (2 pieces)



#### For vac pac unit mount type

Run the wiring and tubing of step 5 through the bottom cover bracket of the PCB unit and through the chair to the junction unit.

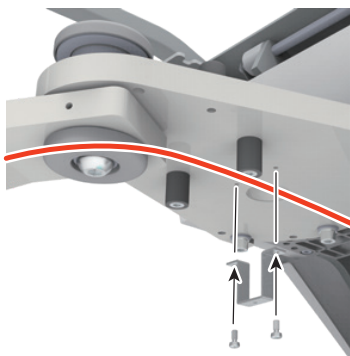
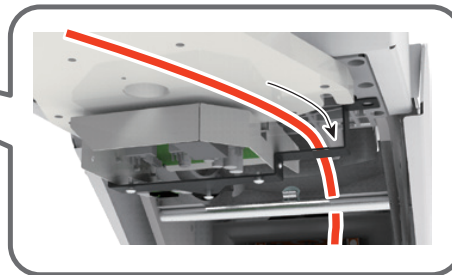

9. Attach the bracket, reversing Procedure 7.

Attach it to arrange the wiring and tubing.

### 3 Installation

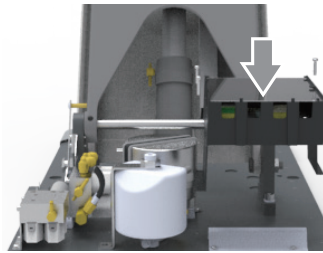

10. Attach the PCB box.

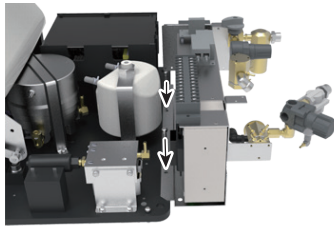

11. Attach the junction unit to the chair.

Fix the junction unit with pan head screws, 2P, M5 × 10, plated (2 pieces).



12. Attach upper cover of the balance arm reversing Procedure 4.



13. Attach the end-cap set to the balance arm.

Fix the end-cap with pan head screws, M4 × 10, SUS (2 pieces).



14. With clean water system.

Attach the clean water system cover.

Fix the cover with P-type pan head screws, M4 × 16, plated (2 pieces).

Without clean water system.

⇒Go to Procedure 15.

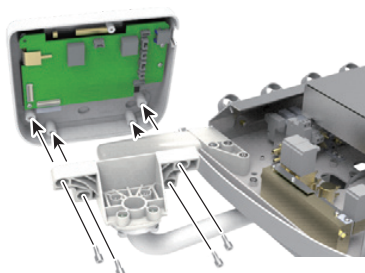

15. Attach the operation panel to the doctor table

Fix the panel with the cap bolts, 2P, M5 × 10, SUS (4 pieces).

### 3 Installation

16. Attach the back cover of operation panel.

- (1) Connect the 2 connectors from the doctor table and the connector from the rear cover speaker to the operation panel PCB as shown in the figure.

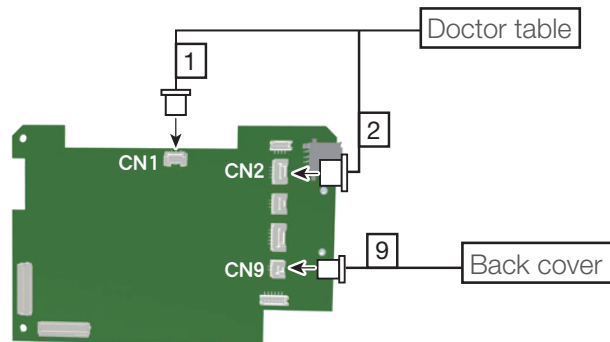
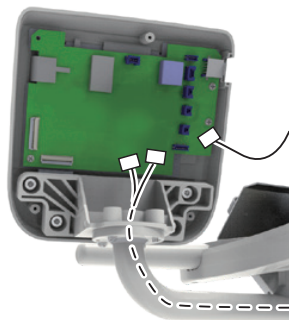

- (2) Fix the cover with the pan head screws, 2P, M3 × 8, SUS (4 pieces).

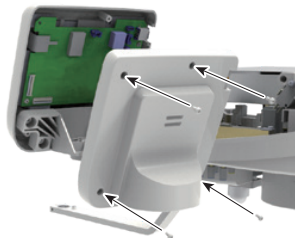

17. Attach the rest holder.

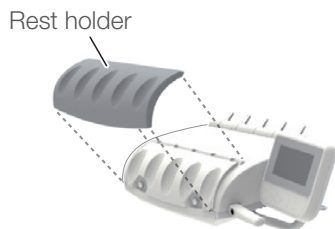

18. Attach the tray holder to the arm.

- (1) Put the brake ring on the arm and put the tray holder on it.

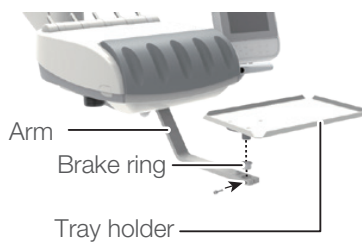

- (2) Fix the tray with the cap bolt, M5 × 25, SUS (1 piece).

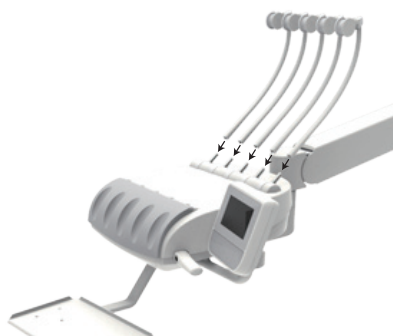

19. Insert the rod arm to the doctor table.

## 3 Installation

### 3-3-5 Installing the dental light

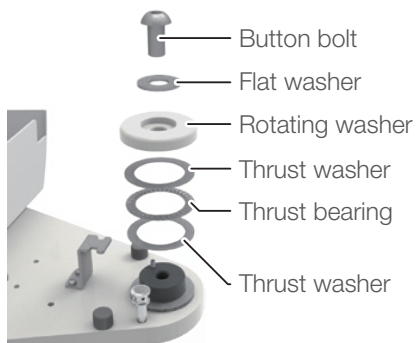

#### 1. Attach the light swing arm.

##### (1) Remove the following parts from the light mounting bracket.

Button bolt  
Flat washer  
Rotating washer  
Thrust washer, Thrust bearing, Thrust washer (1 set only)

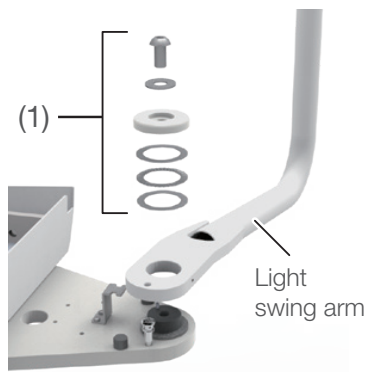

##### (2) Set the light swing arm hole and fix it with the parts taken out in the procedure (1)

Align the hole of the rotating washer with the pin of the light mounting bracket and fix it.

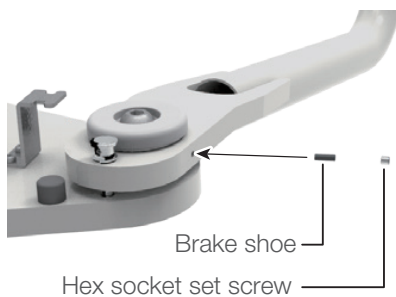
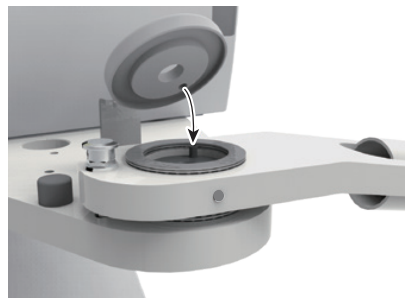

#### 2. Attach the brake shoe.

Fix the brake shoe with hex socket set screw, M6 × 6, SUS (1 piece).

### 3 Installation

#### 3. Drop the chair to its lowest position.

Base mount

Connect the chair lowering connector (connector 2) to the chair operation line connected to the chair board.

The chair will be lowered when the connector is connected, so disconnect the connector when it is lowered to the lowest position.

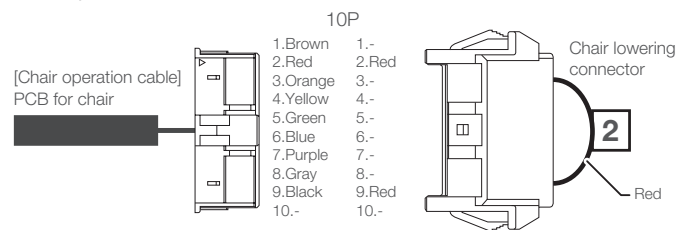

Make sure to insert a connector until it clicks.

When disconnecting a plug, do not pull the cable but hold the connector and pull it.

#### WARNING

When connecting the connector, pay close attention to the direction in which the chair is lowered, and ensure that the chair does not contact any body parts, hands or feet, or objects.

Body parts, hands or feet, or objects may become caught in the chair, causing injury or damage to peripheral devices.

⇒ Go to Procedure 4.

Cart / Swing mount

Tilt the stick switch for the chair manual operation down to drop the chair to its lowest position.

#### 4. Pass the lead cable in the arm of the dental light through the light swing arm.



### 3 Installation

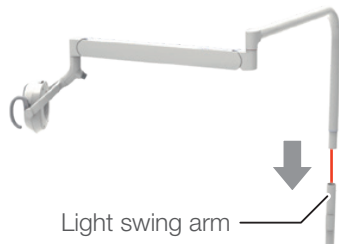

5. Insert the arm of the dental light to the light swing arm.

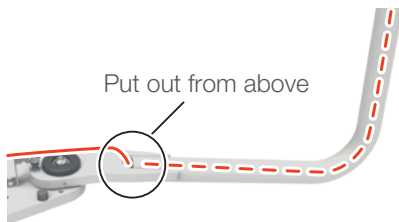

6. Put out the lead cable from the position shown in the figure.

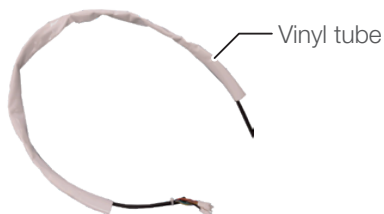

7. Pass through the lead cable in the step 6 to the vinyl tube.

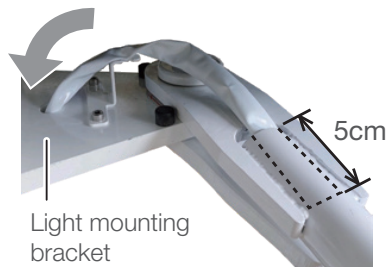

8. Insert 5cm of the vinyl tube to the end of the light swing arm.

9. Pass the lead cable with vinyl tube through the hole on the light mounting bracket.

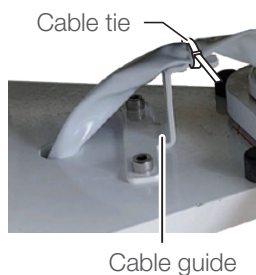

10. Fix the lead cable in the arm to the cable guide with cable tie.

Make sure the light swing arm is in front of the chair and then fix the lead cable in the arm.

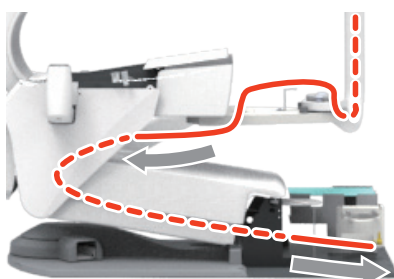

11. Pass the lead cable in the arm to the junction unit of the chair.



### 3-3-6 Wiring / Piping

#### 3-3-6-1 Cuspidor unit type

#### Wiring / piping inside the junction unit

##### 1. Attach the connector.

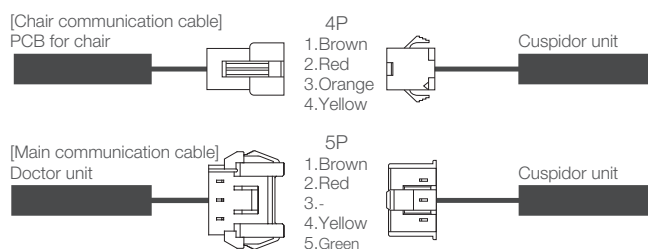

##### Base mount only

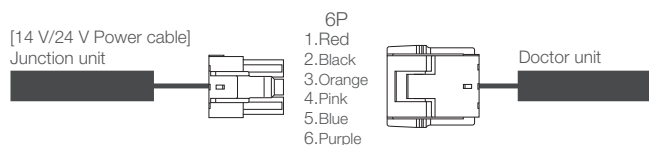
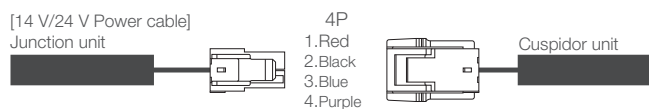
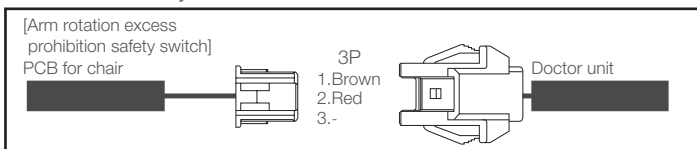

##### (Option)

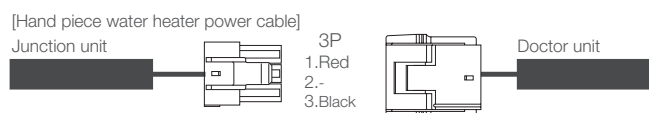
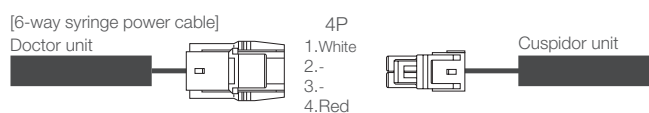
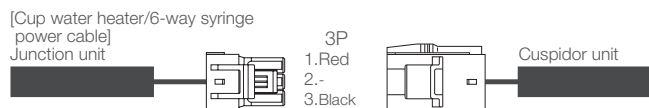
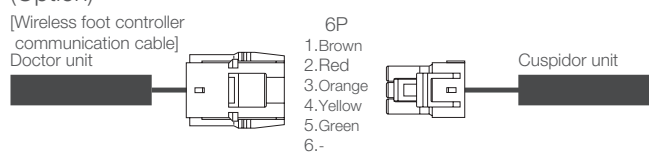

### 3 Installation

#### When EURUS LIGHT is installed

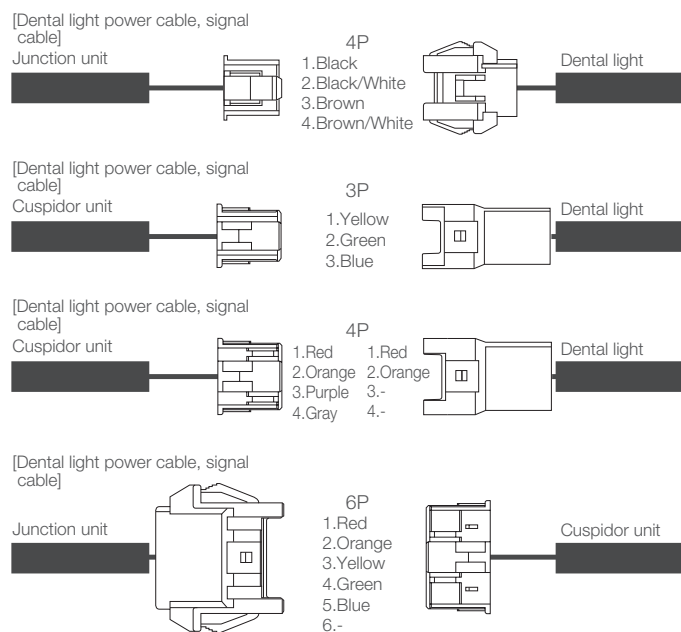

#### When 900 DENTAL LIGHT is installed

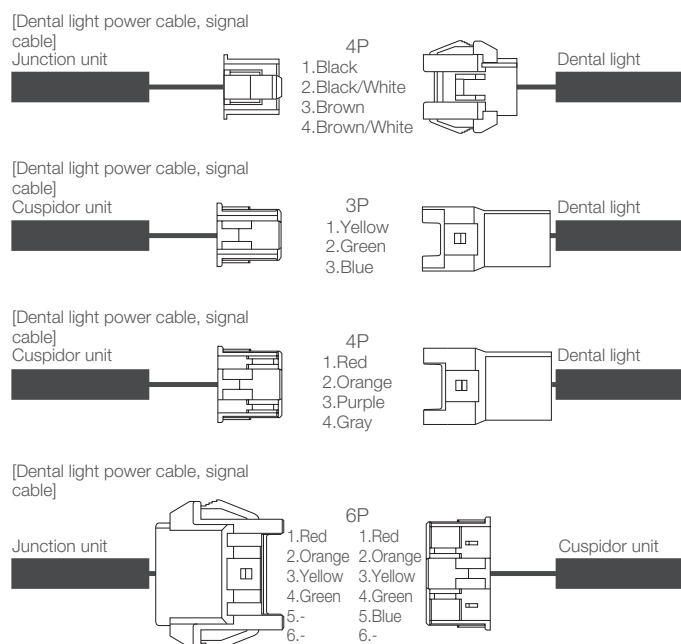

Make sure to insert a connector until it clicks.

When disconnecting a plug, do not pull the cable but hold the connector and pull it.

### 3 Installation

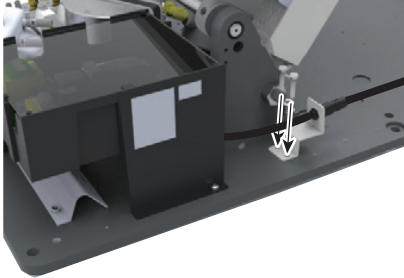

#### For wired foot controller

2. Attach the metal fitting of the foot controller cable to the chair.  
Fix the metal fitting with pan head screws, 2P, M5 × 8, plated (2 pieces).
3. Attach the connector of the cable for foot controller that is passed from the cuspidor unit to the chair to the connector of the cable attached in Procedure 2.

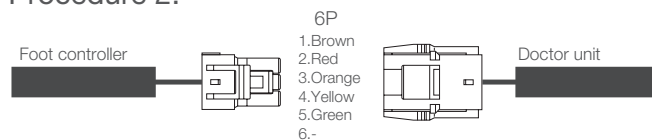

Make sure to insert a connector until it clicks.

When disconnecting a plug, do not pull the cable but hold the connector and pull it.

⇒Go to Procedure 4.

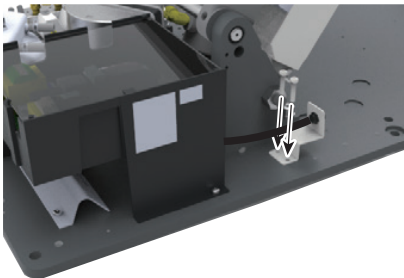

#### For wireless foot controller

2. Attach the metal fitting of the connector for foot controller to the chair.  
Fix the metal fitting with pan head screws, 2P, M5 × 8, plated (2 pieces).
3. Attach the connector of the cable for foot controller that is passed from the cuspidor unit to the chair to the connector attached in Procedure 2.



Make sure to insert a connector until it clicks.

When disconnecting a plug, do not pull the cable but hold the connector and pull it.

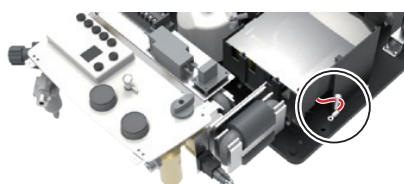

4. Attach the ground wires of the connector for foot controller to the base plate.  
Fix the ground wires with pan head screw, 3P, M4 × 10, plated (1 piece) and toothed lock washer, M4 (1 piece).

### 3 Installation

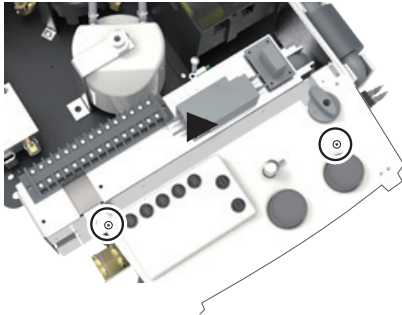

5. Remove the maintenance panel.  
Remove the truss screws, M4 × 10, white (2 pieces).

6. Connect the tubes of the cuspidor unit and doctor unit to the junction unit.

Base mount / Cart

: Tubes of the cuspidor unit  
 : Tubes of the doctor unit

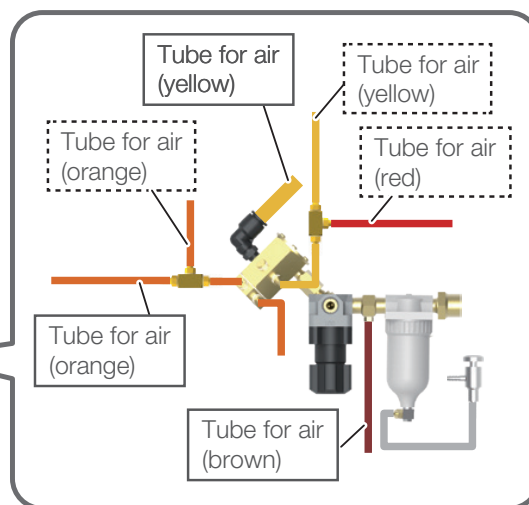
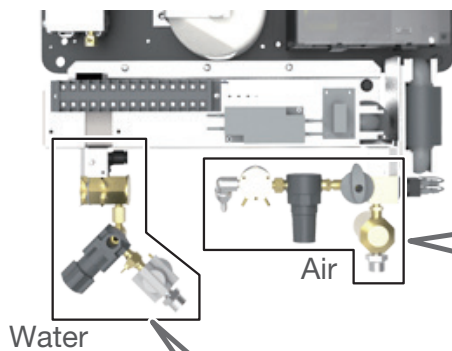

Without clean water system.

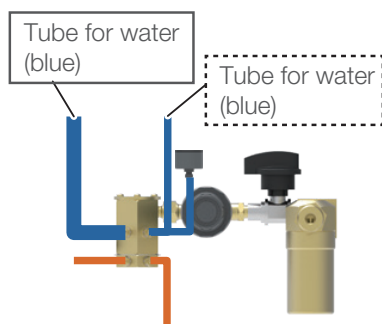

With clean water system. (with WATER toggle switch)

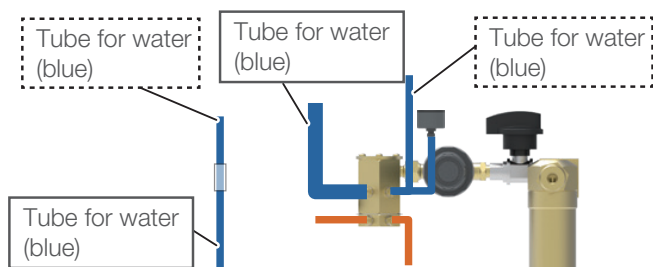

With clean water system. (without WATER toggle switch)

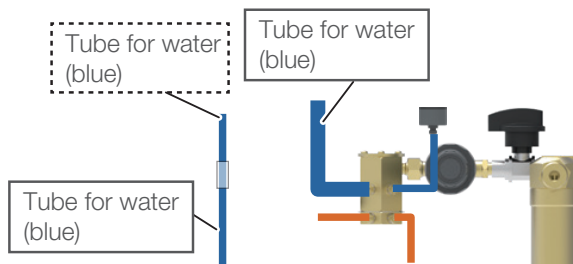

### 3 Installation

#### Swing mount

##### Without clean water system.

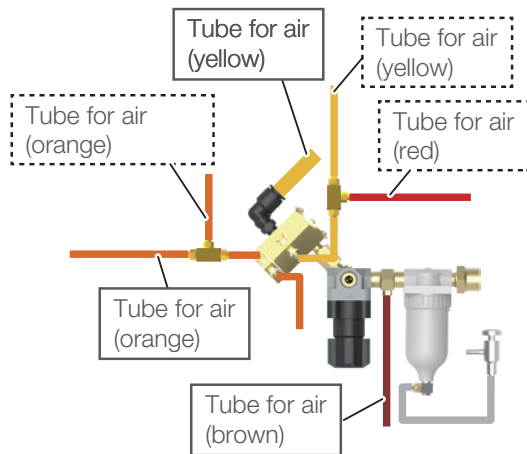

##### With clean water system.

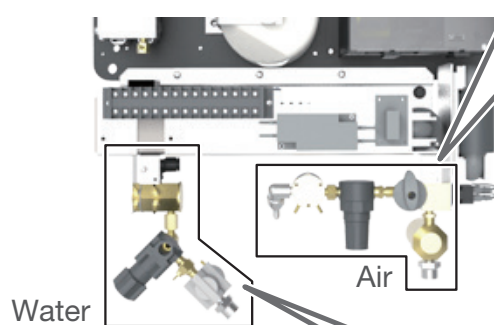
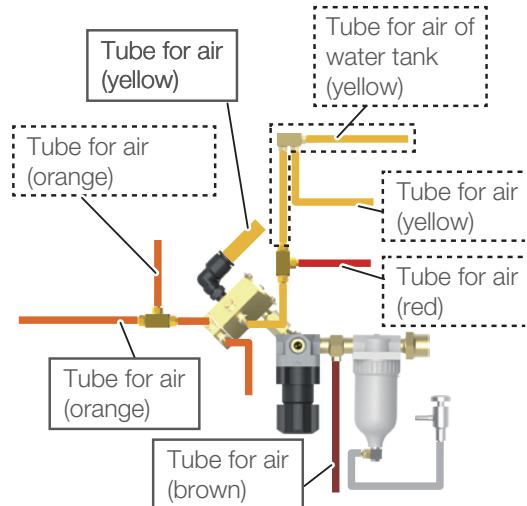

##### Without clean water system.

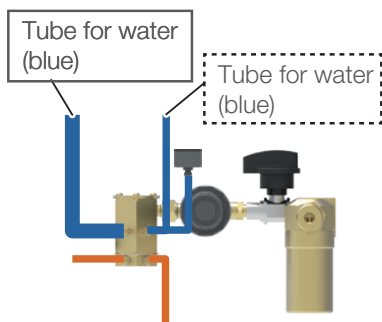

##### With clean water system. (with WATER toggle switch)

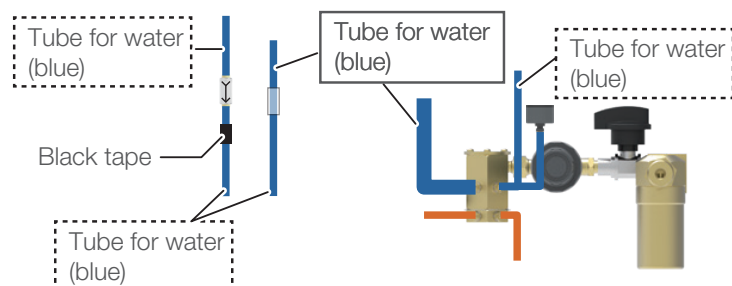

##### With clean water system. (without WATER toggle switch)

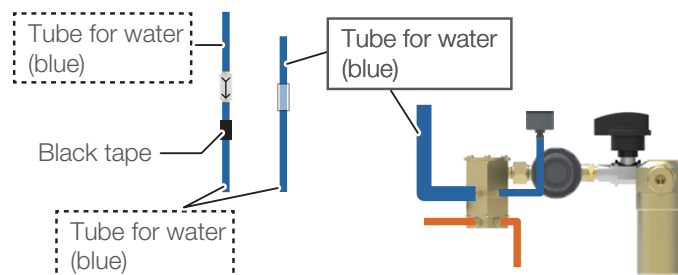

### 3 Installation

7. Lay pipes for water, air, drain, and vacuum.

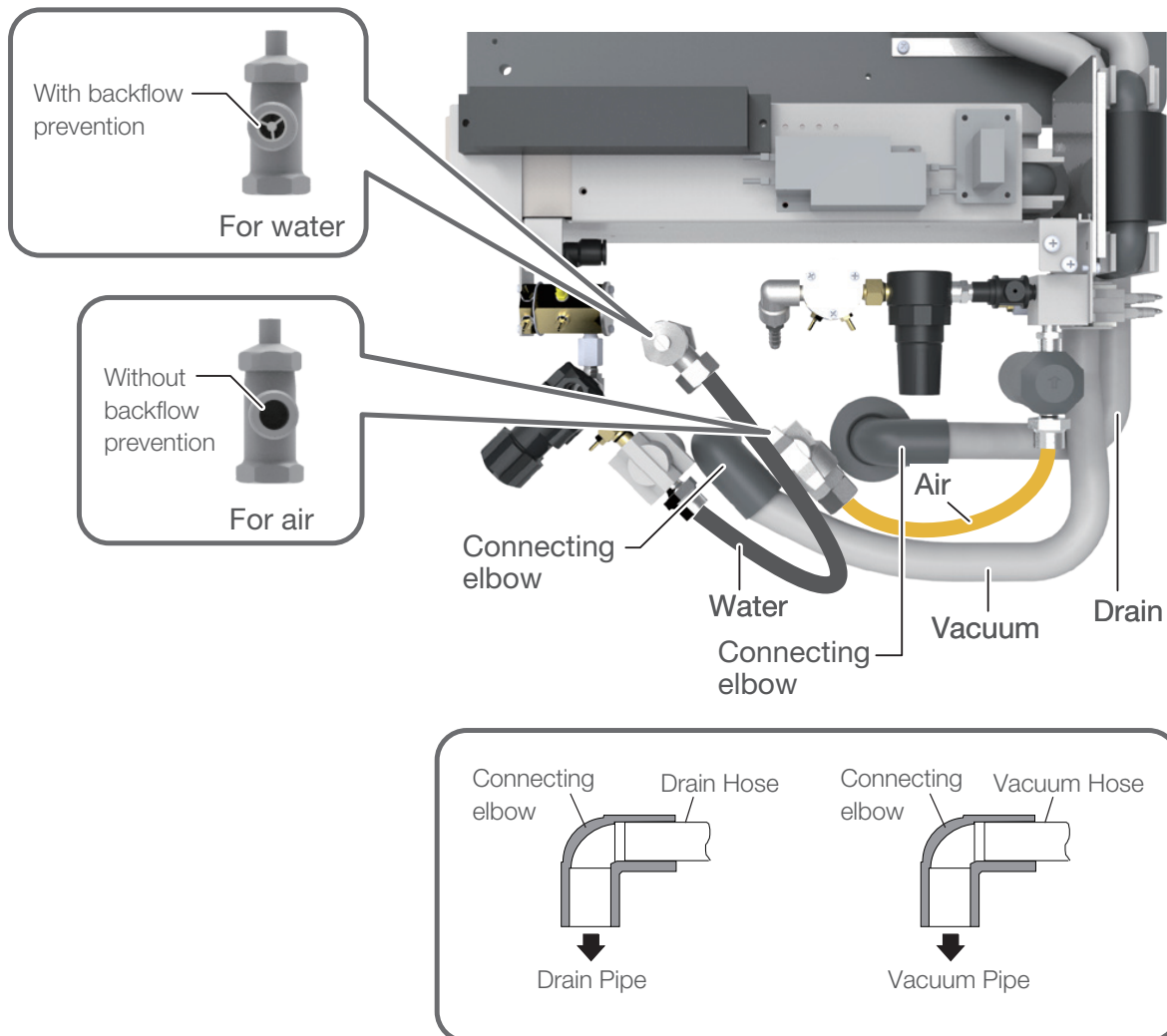

Route the drain hose in a low position.  
If you handle it at a high position, the drainage flow will be impaired.

8. Attach the maintenance panel reversing Procedure 5.

### 3-3-6-2 Vac Pac unit type

#### Wiring / piping inside the junction unit

##### 1. Attach the connector.

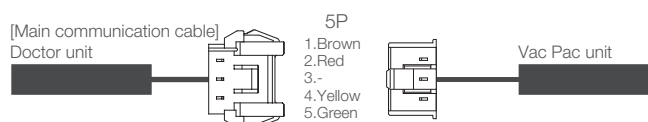

##### Base mount only

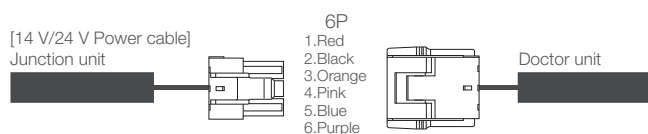
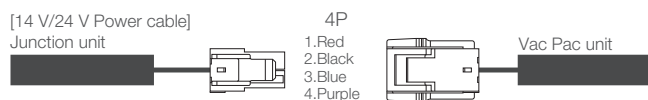
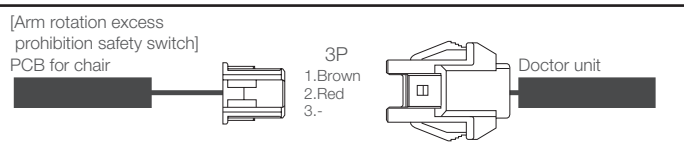

##### (Option)

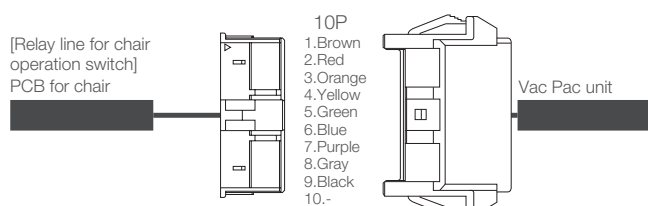
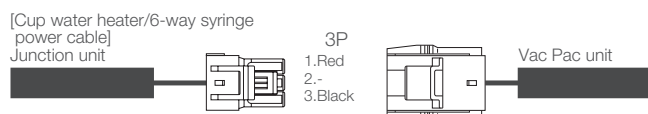
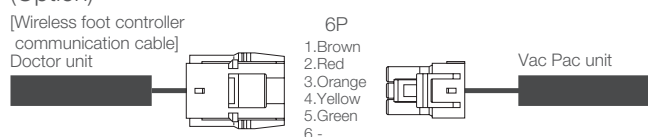

### 3 Installation

#### When EURUS LIGHT is installed

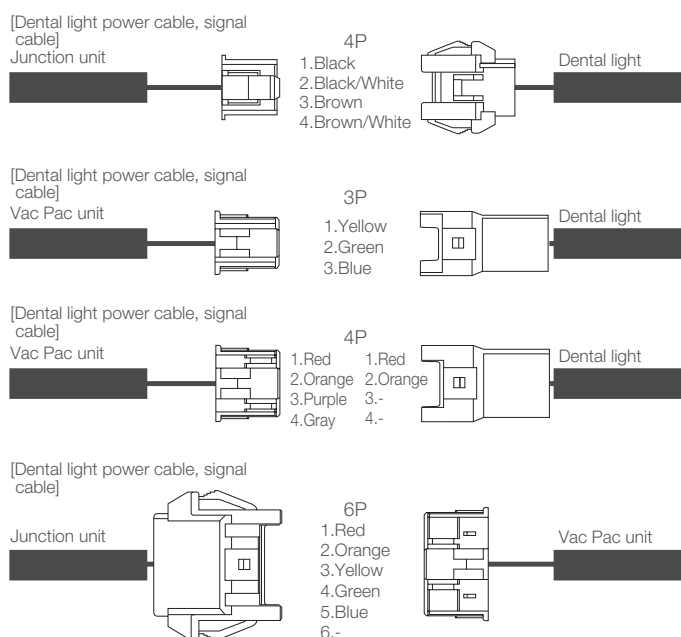

#### When 900 DENTAL LIGHT is installed

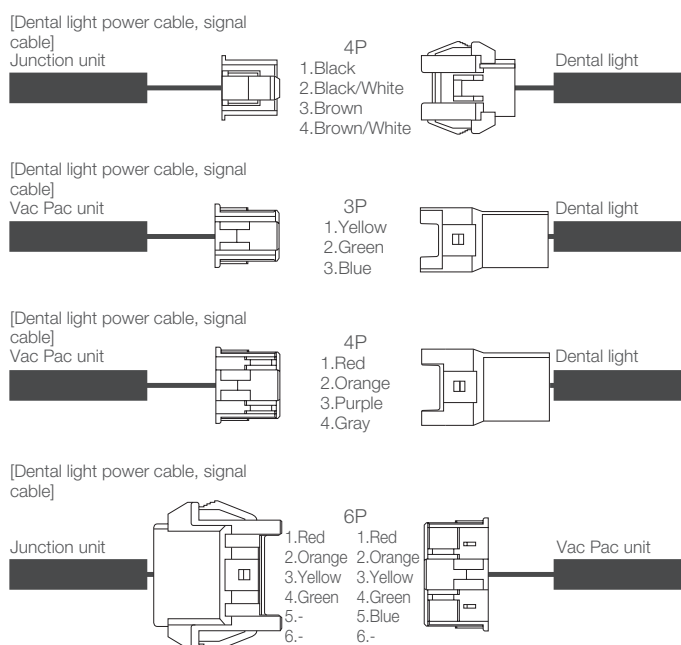

Make sure to insert a connector until it clicks.

When disconnecting a plug, do not pull the cable but hold the connector and pull it.



### 3 Installation

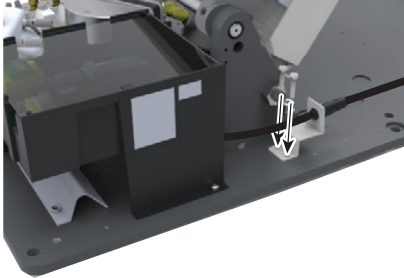

#### For wired foot controller

2. Attach the metal fitting of the foot controller cable to the chair.  
Fix the metal fitting with pan head screws, 2P, M5 × 8, plated (2 pieces).
3. Attach the connector of the cable for foot controller that is passed from the cuspidor unit to the chair to the connector of the cable attached in Procedure 2.

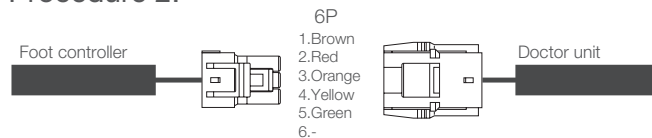

Make sure to insert a connector until it clicks.

When disconnecting a plug, do not pull the cable but hold the connector and pull it.

⇒ Go to Procedure 4.

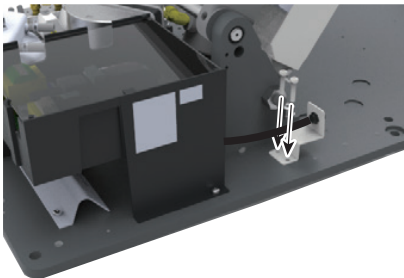

#### For wireless foot controller

2. Attach the metal fitting of the connector for foot controller to the chair.  
Fix the metal fitting with pan head screws, 2P, M5 × 8, plated (2 pieces).
3. Attach the connector of the cable for foot controller that is passed from the Vac Pac unit to the chair to the connector attached in Procedure 2.

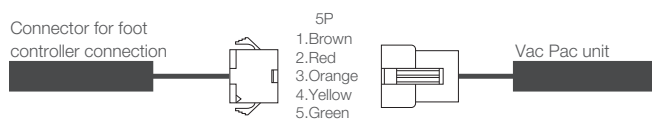

Make sure to insert a connector until it clicks.

When disconnecting a plug, do not pull the cable but hold the connector and pull it.



4. Attach the ground wires of the connector for foot controller to the base plate.  
Fix the ground wires with pan head screw, 3P, M4 × 10, plated (1 piece) and toothed lock washer, M4 (1 piece).

### 3 Installation

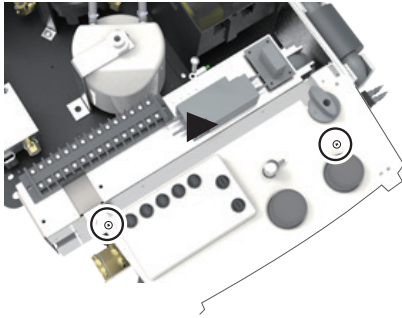

5. Remove the maintenance panel.  
Remove the truss screws, M4 × 10, white (2 pieces).

6. Connect the tubes of the cuspidor unit and doctor unit to the junction unit.

Base mount / Cart

: Tubes of the Vac Pac unit  
 : Tubes of the doctor unit

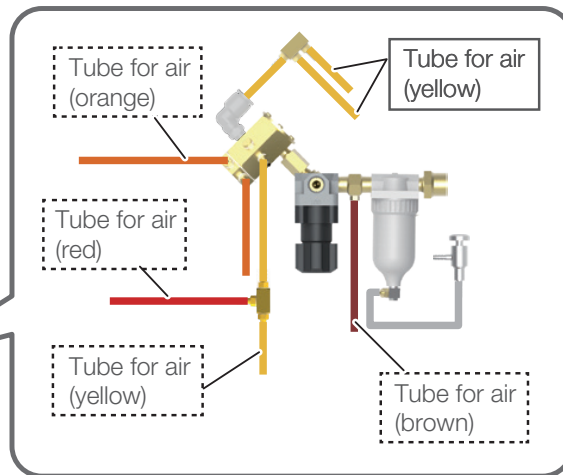
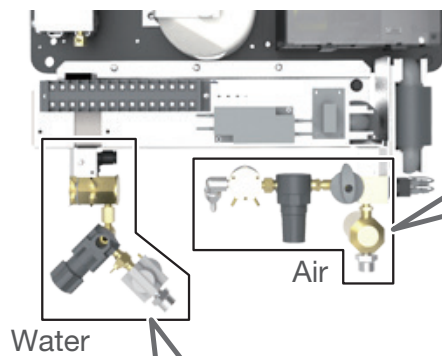

Without clean water system.

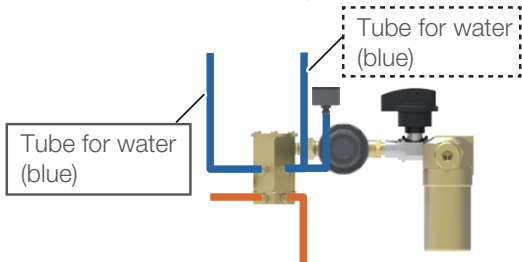

With clean water system.

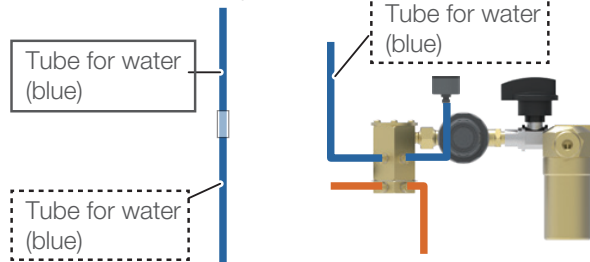

### 3 Installation

#### Swing mount

##### Without clean water system.

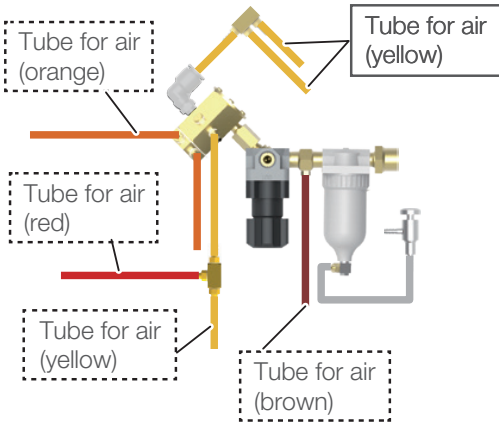

##### With clean water system.

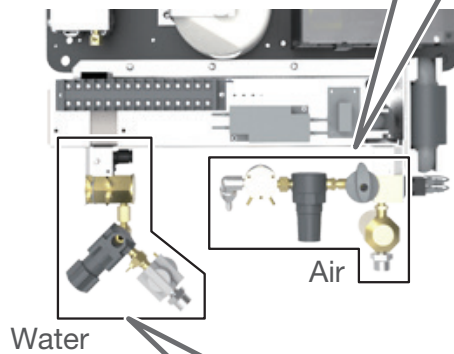
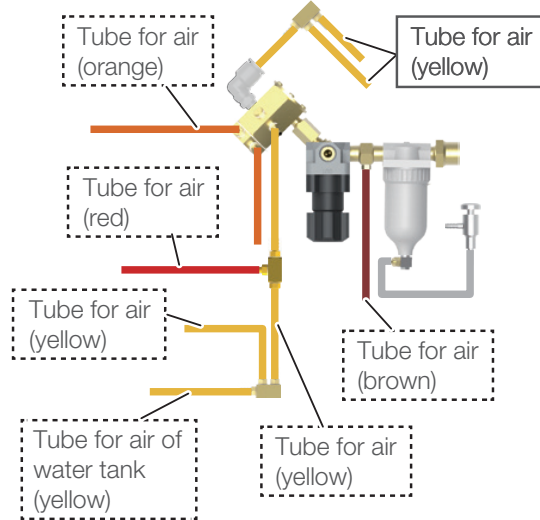

: Tubes of the Vac Pac unit  
 : Tubes of the doctor unit

##### Without clean water system.

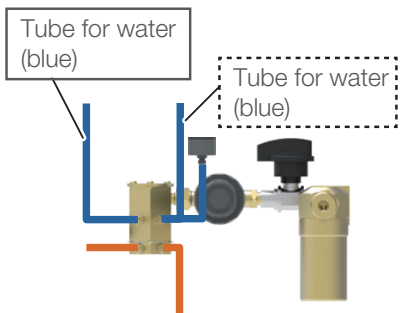

##### With clean water system.

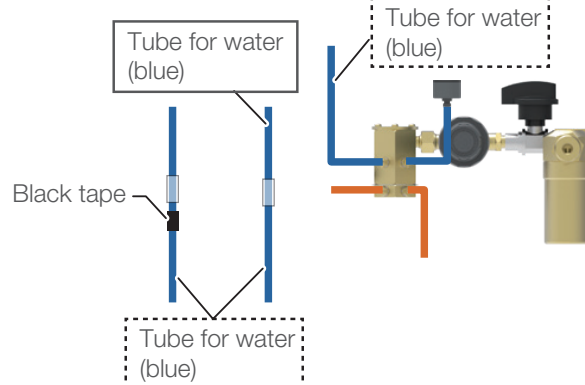

### 3 Installation

7. Lay pipes for water, air, and vacuum.

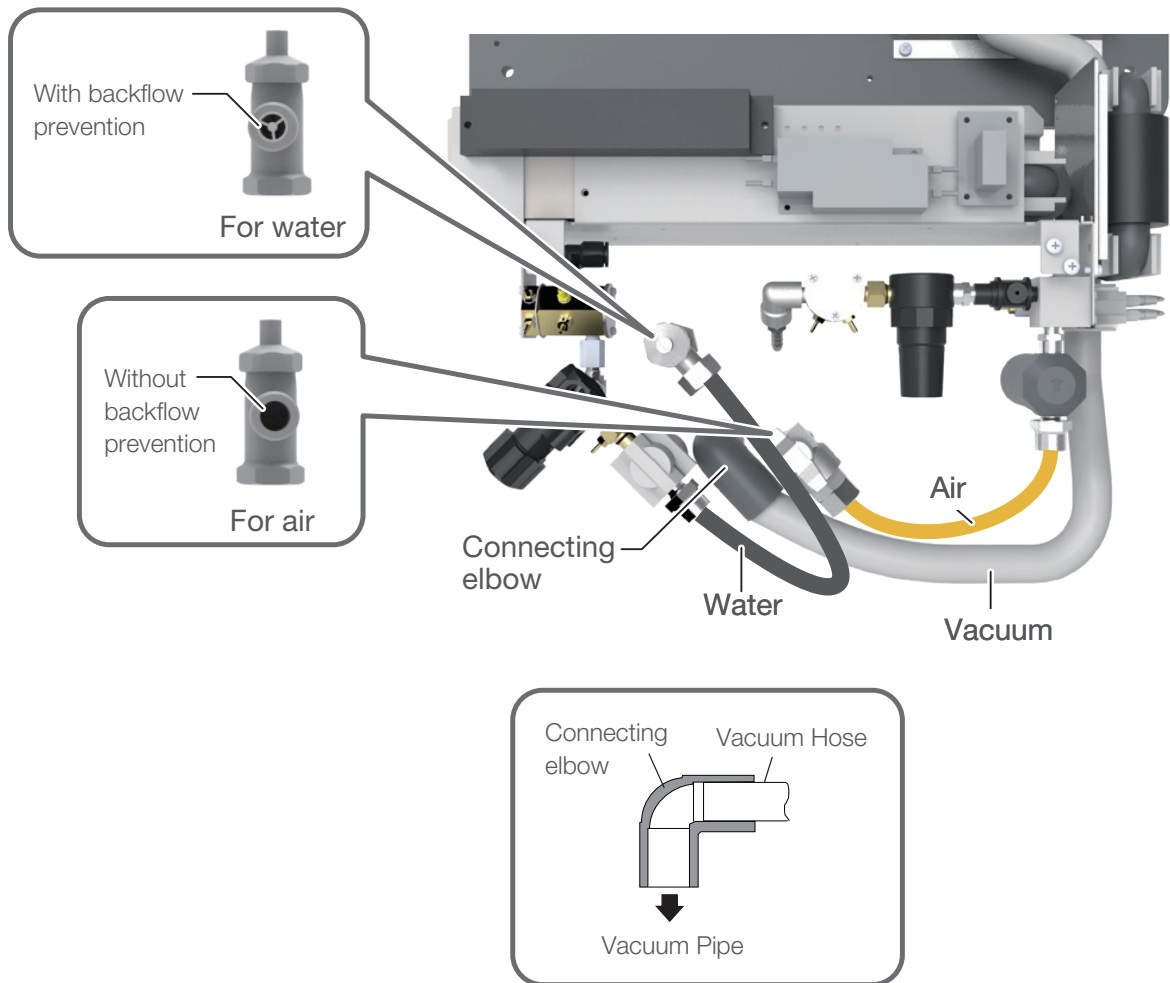

8. Attach the maintenance panel reversing Procedure 5.

### 3-3-7 Checking for proper operation

1. Disconnect the terminal block from the connector of the power cable for the chair.

- (1) Disconnect the power plug that connects the terminal block from the power supply outlet.
- (2) Disconnect the connector of the terminal block.

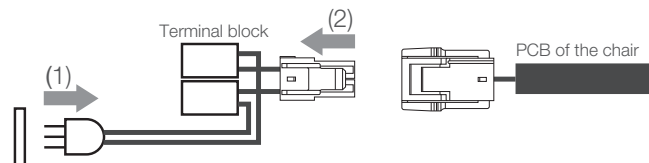

2. Attach the connector of the power cable of the chair to the appropriate connector in the junction unit.



Make sure to insert a connector until it clicks.

When disconnecting a plug, do not pull the cable but hold the connector and pull it.

3. Insert the power plug of this product into a suitable power supply outlet.
4. Turn on the main switch and open the water main valve.
5. Confirm that the water pressure is 0.2 MPa and the air pressure is 0.5 MPa by the pressure gauge.  
If not, adjust the pressure using the pressure reducing valves.
6. Put a paper cup on the cup filler and push the cup filler switch several times until water comes from the cup filler nozzle.
7. Flush out the air in the water piping several times.
8. Check for the proper operation of the equipment.

## 3 Installation

### 3-3-8 Setting the lower volume limit of the dental light intensity



#### 1. For cuspidor unit

Remove the PCB cover of the cuspidor unit.

Remove the pan head screw, 3P, M4 × 8, plated (1 piece).

#### For Vac Pac unit

Go to Procedure 2.



2. Turn on the power of the unit.

3. Turn the light intensity control volume of the dental light counterclockwise to its lowest setting.

4. Push the switch (SW3, CHECK) on the assistant PCB in the cuspidor unit.

LED5 (Orange) on the assistant PCB brinks.

5. Push the switch (SW4 ON\_OFF) on the assistant PCB.

LED5 (Orange) on the assistant PCB turns off.

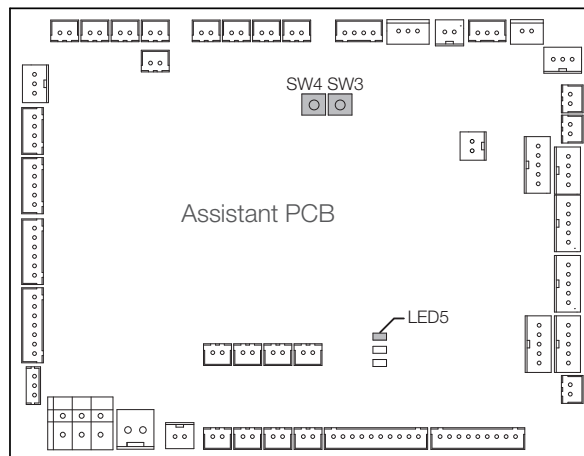

#### For cuspidor unit

6. Attach the PCB cover reversing Procedure 1.

## 3 Installation

### 3-3-9 Installing the seat, backrest, and other parts of the chair

#### 1. Attach the headrest unit.

For the manual headrest :

Attach the headrest unit with cap bolts, M8 × 20, plated (4 pieces).

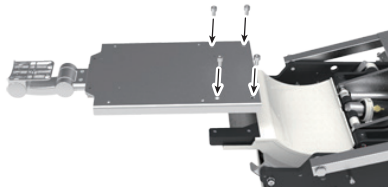

For the power headrest :

(1) Attach the headrest unit with cap bolts, M8 × 20, plated (4 pieces).



(2) Confirm that the tubing of the headrest unit (back side) is properly passed as shown in the figure.



#### 2. Raise the backrest.

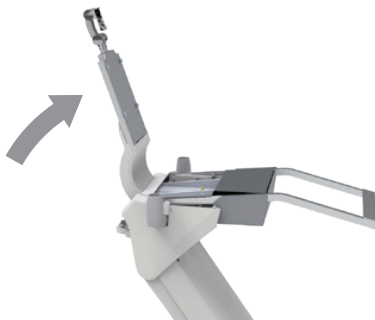

### 3 Installation

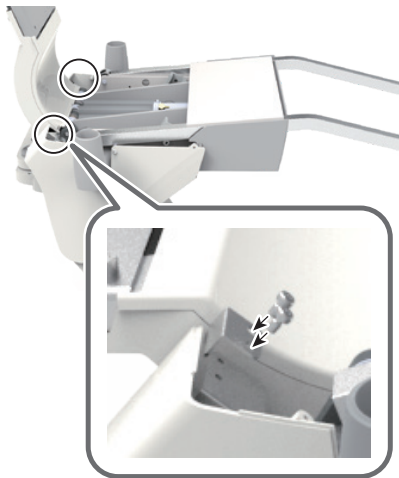

3. Attach the flange cover spacer (1 piece each on right and left).  
Fix the spacer with pan head screws, 2P, M5 × 10, plated (2 pieces each on right and left).

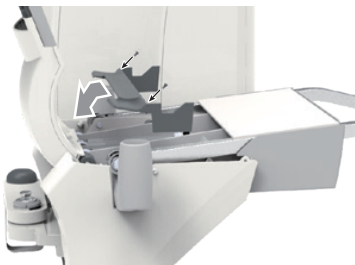

4. Attach the flange cover top.  
Fix the cover with pan head screws, 2P, M4 × 10, plated (2 pieces).

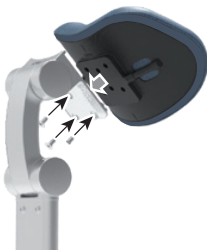

5. Attach the headrest.

For the manual headrest :

- (1) Attach the headrest to the headrest unit.

Fix the headrest with the countersunk screws, M5 × 8, plated (3 pieces).



- (2) Attach the headrest cover.

Insert the catches of the headrest cover to the catches on the mounting part.



### 3 Installation

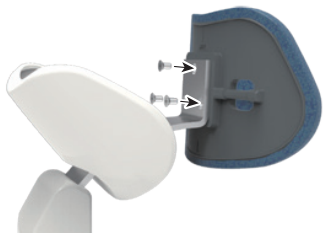

For the power headrest :

(1) Insert the headrest cover to the headrest support arm.

(2) Attach the headrest to the headrest unit.

Fix the headrest with the countersunk screws, M5 × 8, plated (3 pieces).

(3) Attach the headrest cover.

Insert the catches of the headrest cover to the catches on the mounting part.



6. Attach the backrest.

Fix the backrest with pan head screws, 2P, M5 × 10, plated, (4 pieces).



7. Attach the backrest cover.

Insert the catches of the backrest cover to the catches on the mounting part.



8. Attach the seat bottom covers (right and left) to the seat.

(1) Attach the hex spacers, M4 × 8 (3 pieces) to the left side of the seat.

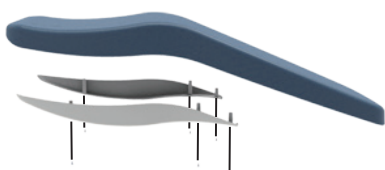

(2) Fix the covers with binding head screws, M4 × 15, plated (6 pieces).

### 3 Installation

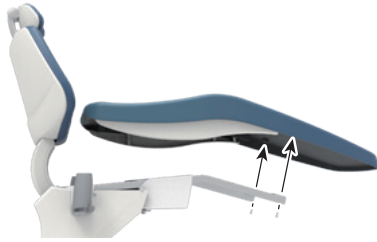

#### 9. Attach the seat.

Hook the rear side of the seat to the seat frame and fix the front side of the seat with pan head screws, 2P, M6 × 15, plated, (2 pieces) and flat washers, 7 × 19 × 2.0 (2 pieces).

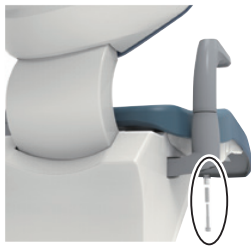

#### 10. Attach the armrest (right and left).

Insert the armrest and fix it with the following:

Cap bolt, M6 × 45, black (1 piece each on right and left)

Spacer, 6 × 30 (1 piece each on right and left)

Spring (1 piece each on right and left)

Flat washer, M6 × 11.5 × 0.8 (1 piece each on right and left)

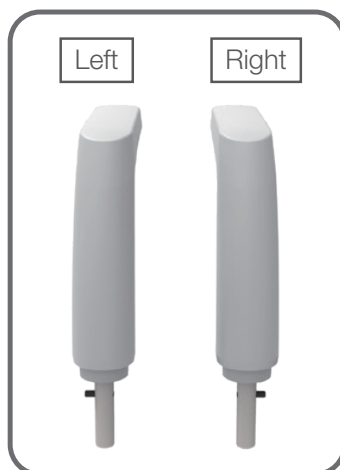

## 3 Installation

### 3-3-10 Positioning / Fix

#### 1. Determine the position of each unit.

Consult dentists and staff to determine the position.  
Refer to the [ 3-1-1 Distance within the treatment room ]  
(page 7-8) for a standard position.

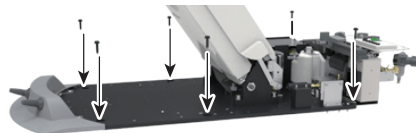
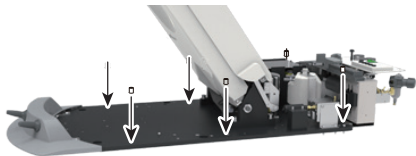

#### 2. Fix the chair to the floor.

(1) When necessary, adjust the level by using the attached hex socket set screws, M10×10, SUS (6 pieces).  
Depends on the situation of the floor surface (e.g. hex socket set screws are sunk ), insert the metal plate between the hex socket set screws and floor, then adjust the level.

(2) Fix the chair with hex head flange screw TP-A, M8 × 30, black, (6 pieces).

Cart

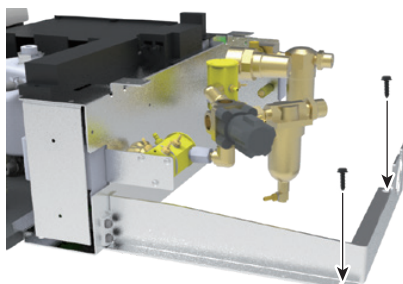

#### 3. Fix the cart hose bracket to the floor.

Fix the cart hose bracket with hex head flange screw TP-A, M8 × 30, black (2 pieces).

## 3 Installation

### 3-3-11 Attaching the cover

#### Cuspidor unit

1. Attach the side panel (front) (both right and left).
  - (1) Insert the upper part of the panel and mate the projection on the cutout of the cuspidor.

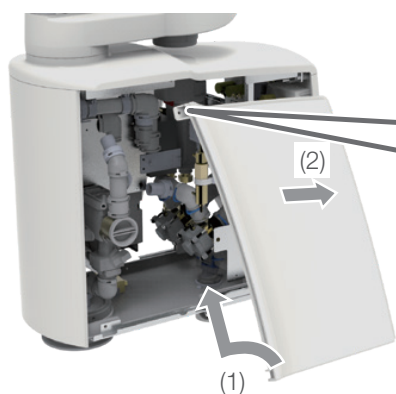

- (2) Slide the panel to front side.



- (3) Fix the panel with pan head screws, 3P, M4 × 10, SUS (1 piece each on right and left).



2. Attach the side panel (rear) (both right and left).
  - (1) Insert the upper part of the panel and mate the projection on the cutout of the cuspidor.

- (2) Slide the panel to front side.



- (3) Fix the panel with knurled screw, M4x8, plated (1 piece each on right and left).

### 3 Installation



#### 3. Attach the cuspidor bowl.

Engage the bottom of the cuspidor bowl at the position shown in the figure.

Do not allow any metal object to come into contact with the cuspidor bowl when detaching or reattaching it since contact may leave a metal mark. If the metal object marks the bowl, use a metal mark removing agent (commercially available).

\* A metal mark is a black or silver line caused by strong contact and friction between the ceramic surface and the metal object.

Before detaching or reattaching the cuspidor bowl, always turn off the main switch.

When detaching or reattaching the bowl, the cupfiller sensor may detect your hand or other object, causing water for flushing the bowl to splash around, which can cause metal parts to rust.

The cuspidor bowl is made of ceramic. It may break if it receives a hard knock.

#### Cuspidor unit / Vac Pac unit

Rubber cap

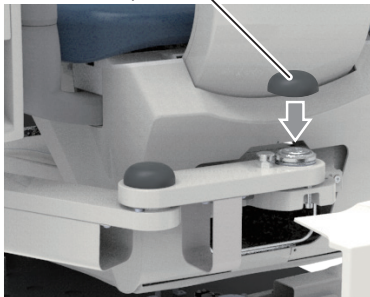

#### 1. Attach the rubber cap.

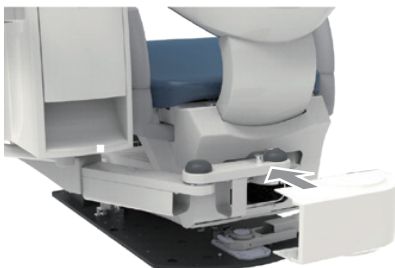

#### 2. Attach the swing bracket cover to the swing bracket.

### 3 Installation

#### Chair

For Vac Pac unit type (Base mount / Cart)

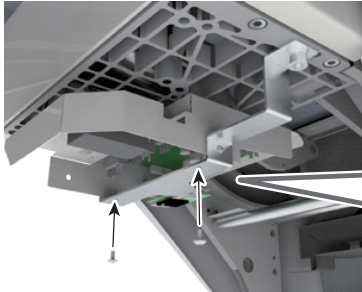

1. Temporarily fix the truss screws, M5 × 10, white (2 pieces), keeping the space between the head of screw and the connecting point about 5 mm.



2. Put the screw head through the hole of the PCB cover and slide it into the position.

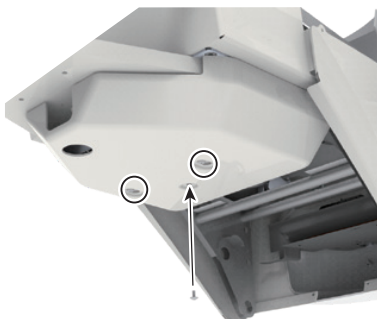

3. Fix the PCB cover with the truss screw, M5 × 10, white (1 piece) and the screws fixed temporarily in the Procedure 1.



Without the dental light

4. Fix the PCB cover with the truss screw, M4 × 8, white (1 piece).

### 3 Installation

#### For Base mount

1. Cut out the part of the base cover shown with nippers (for resin).

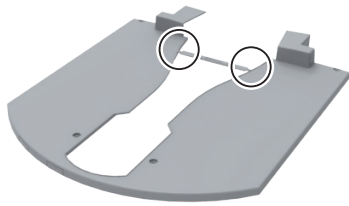

2. Attach the base cover.

Remove the truss head screws, M5 × 10, plated, (4 pieces) set at the connecting points and fix the cover with them.

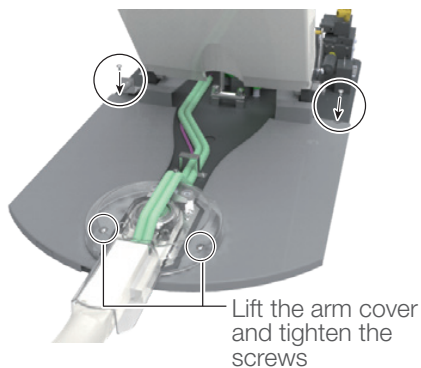

3. Attach the arm cover.

Remove the truss head screws, M4 × 6, plated (2 pieces) set at the connecting points and fix the cover with them.

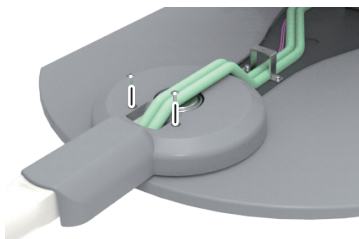

4. Place the hose cover in the mounting position.

Position the piping as shown and fit it inside the hose cover. Make sure that the pipes are not out of the hose cover or pinched under the hose cover.

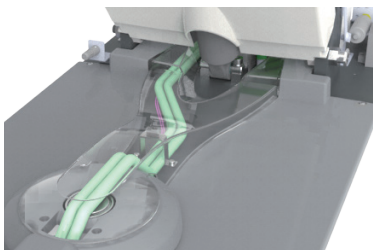

5. Attach the hose cover.

Fix the cover with truss head screw, M4 × 6, plated (1 piece).

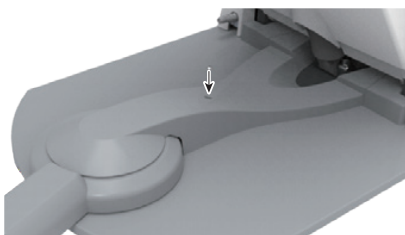

### 3 Installation

#### For Cart

1. Attach the clamps (2 pieces) on the dents of base.



2. Clamp the stick switch cable (one cable only) at the positions (2 places) of marked C.

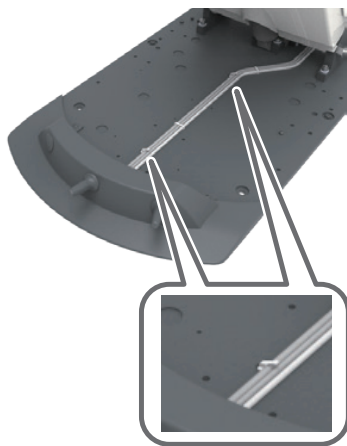

3. Attach the base cover.

Remove the following screws set at the connecting points and fix the base cover with the following screws.

Front side: Truss screws, M5 × 10, plated (2 pieces)

Back side: Truss screws, M4 × 10, plated (2 pieces)

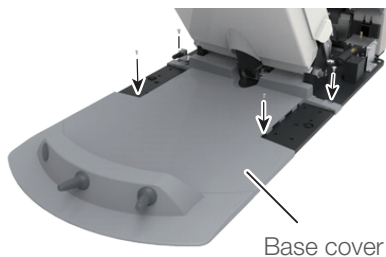

Base cover

4. Attach the base cover lid.

If the base cover lid is difficult to attach, loosen the fixing screws on the front side.

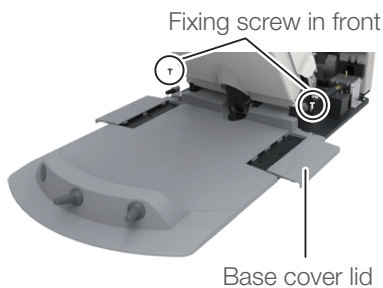

Base cover lid



### 3 Installation

#### For Swing mount



1. Temporarily fix the truss screws, M5 × 10, white (2 pieces), keeping the space between the head of screw and the connecting point about 5 mm.

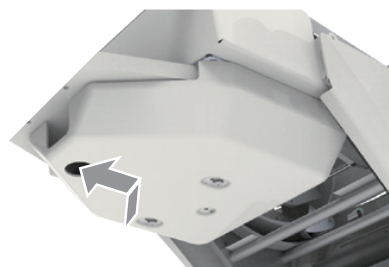

2. Put the screw head through the hole of the bottom cover and slide it into the position.

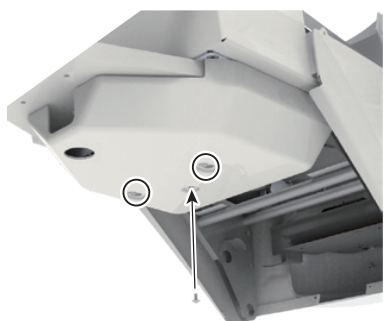

3. Fix the bottom cover with the truss screw, M5 × 10, white (1 piece) and the screws fixed temporarily in the Procedure 1.

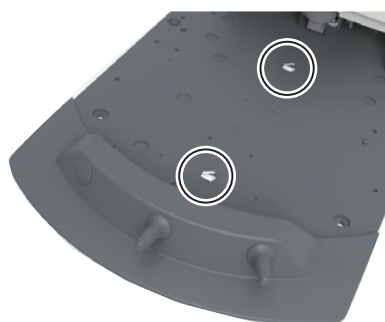

4. Attach the clamps (2 pieces) on the dents of base.

### 3 Installation

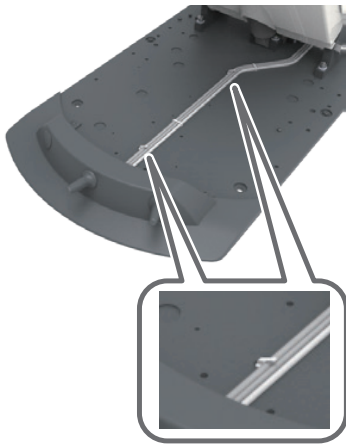

5. Clamp the stick switch cable (one cable only) at the positions (2 places) of marked C.

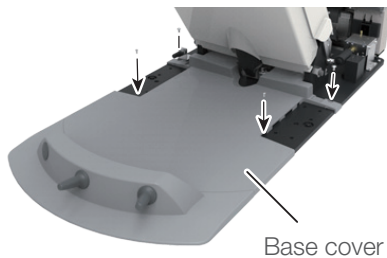

6. Attach the base cover.

Remove the following screws set at the connecting points and fix the base cover with the following screws.

Front side: Truss screws, M5 × 10, plated (2 pieces)

Back side: Truss screws, M4 × 10, plated (2 pieces)

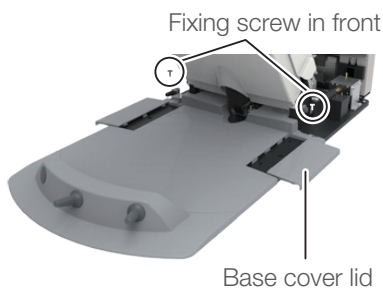

7. Attach the base cover lid.

If the base cover lid is difficult to attach, loosen the fixing screws on the front side.

### 3 Installation

#### Junction unit

##### 1. Without the main switch for chair

Go to Procedure 2.

##### With the main switch for chair

- (1) Cut open the fixing position of the main switch for chair on the junction unit with nippers.

Fixing position of main switch for chair

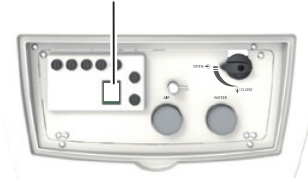

- (2) Disconnect the connectors of the main switch for chair inside the junction unit.

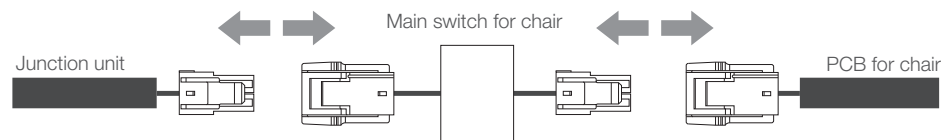

- (3) Insert the main switch for chair to its fixing position.
- (4) Connect the same connectors that were disconnected in Procedure (2).

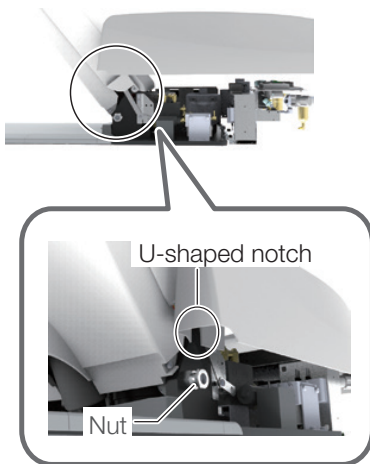

##### 2. Attach the pump cover.

- (1) Insert the U-shaped notch of the pump cover onto the ditch of the nut on the chair link.

### 3 Installation

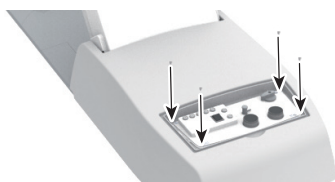

(2) Fix the pump cover with truss screws, M4 × 8, white (4 pieces).

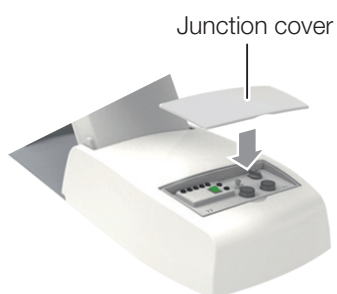

3. Attach the junction cover.

### 3 Installation

#### 3-3-12 Adjustment of doctor unit

##### 3-3-12-1 Adjustment the level of doctor table

Cart

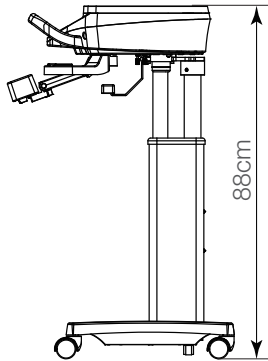

1. Make the table height 88 cm.

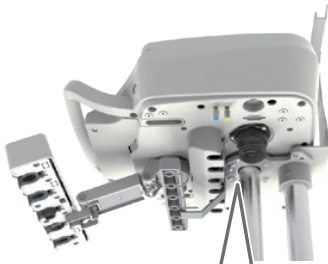

2. Loosen the cap bolts, 2P, M5 × 12, SUS (4 pieces ).

3. Adjustment the level of doctor table.

Use the hex socket set screws M8 × 10 SUS (4 pieces).

After adjustments, tighten the bolts in Procedure 2 and fix it.

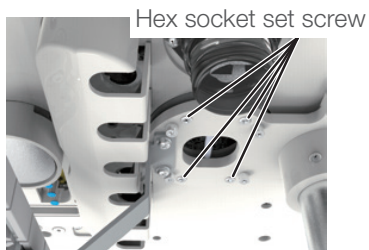
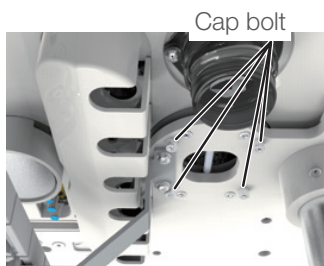

### 3 Installation

#### Swing mount

1. Remove the truss head screws, M4 x 10, white (4 pieces) to remove the lower cover.

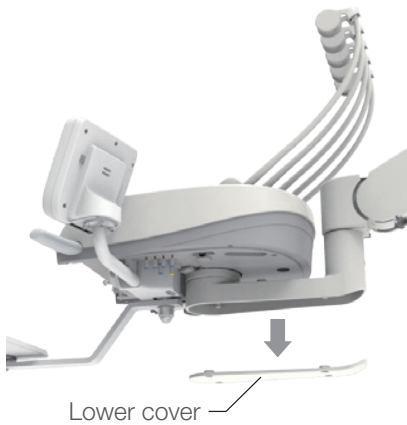

2. Loosen the cap bolts, 2P, M5 x 12, SUS (3 pieces ).

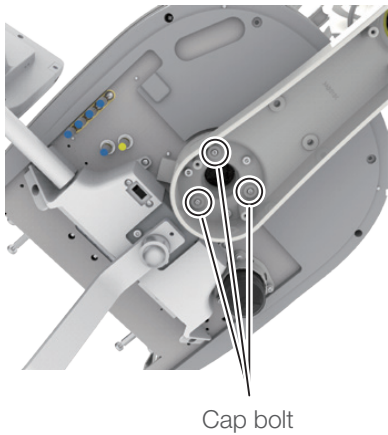

3. Adjustment the level of doctor table.  
Use the hex socket set screws M8 x 10 SUS (3 pieces).  
After adjustments, tighten the bolts in Procedure 2 and fix it.

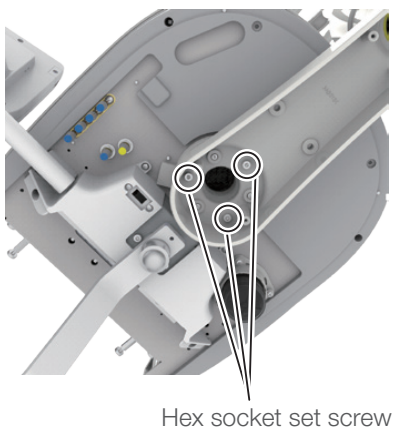

### 3 Installation

#### 3-3-12-2 Adjustment the rotating friction of the table (Swing mount)

1. Remove the rod arm.



2. Remove the rest holder.  
Remove the front panel by unscrewing knurled screws, M5×10, plated (2 pieces).



3. Remove the following screws to remove the upper cover.

Front side: Pan head screws, M4 × 8, plated (2 pieces)

Back side: Pan head screws, M4 × 40, plated (2 pieces)

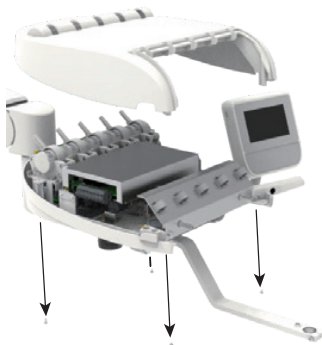

4. Open the PC board box by unscrewing pan head screw, 2P, M4×8, plated (1 piece).

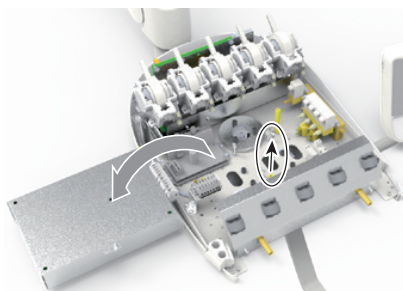

### 3 Installation

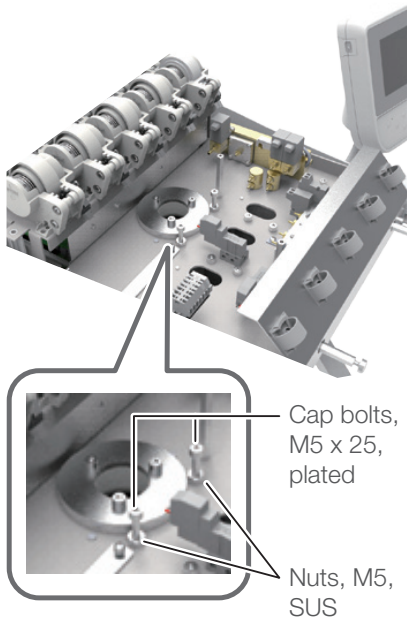

5. To adjust the rotating friction of the table, loosen the two nuts, M5, SUS, then turn the cap bolts, M5 x 25, plated (2 pieces).

Turning the cap bolts clockwise increases the rotating friction.

Turning the cap bolts counterclockwise decreases the rotating friction.

Tighten the nuts after the adjustment



## 3 Installation

### 3-3-12-3 Adjustment of balance arm



1. Remove the end cap for the balance arm.  
Remove the pan head screws, M4 x 10, SUS (2 pieces).

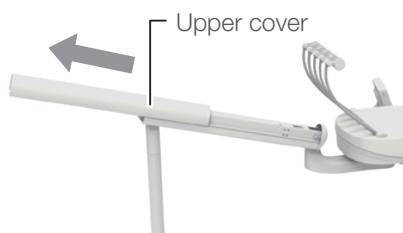

2. Slide the upper cover on the balance arm and remove it

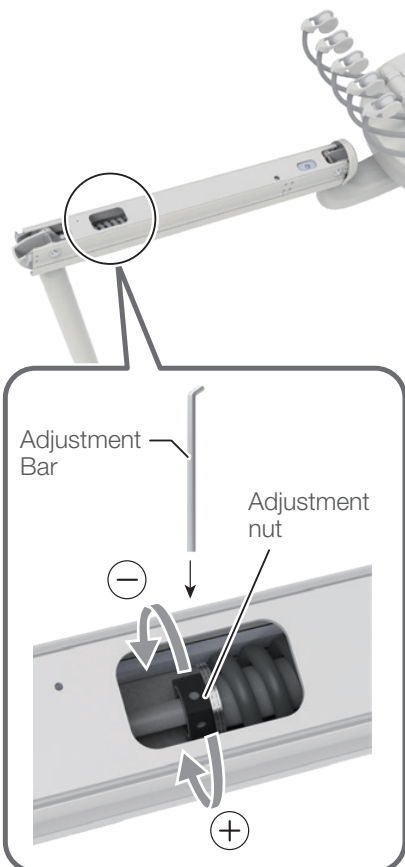

3. Turn the nut and adjust the tension with the adjustment bar.

When the doctor table goes down,  
➡ turn the adjusting nut in the ⊕ direction.

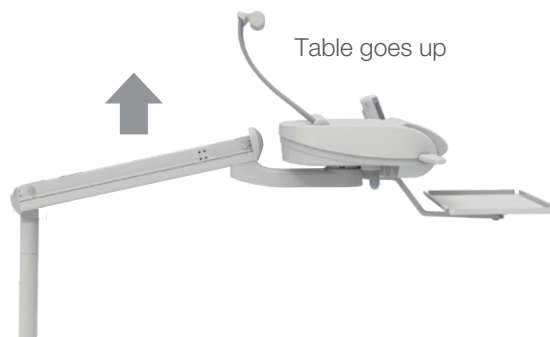

When the doctor table goes up,  
➡ turn the adjusting nut in the ⊖ direction.

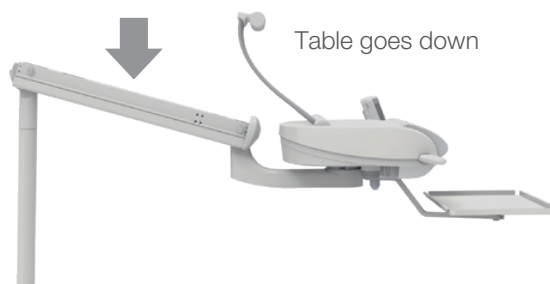

### 3 Installation

#### 3-3-13 Settings for stick switch

Attach the label

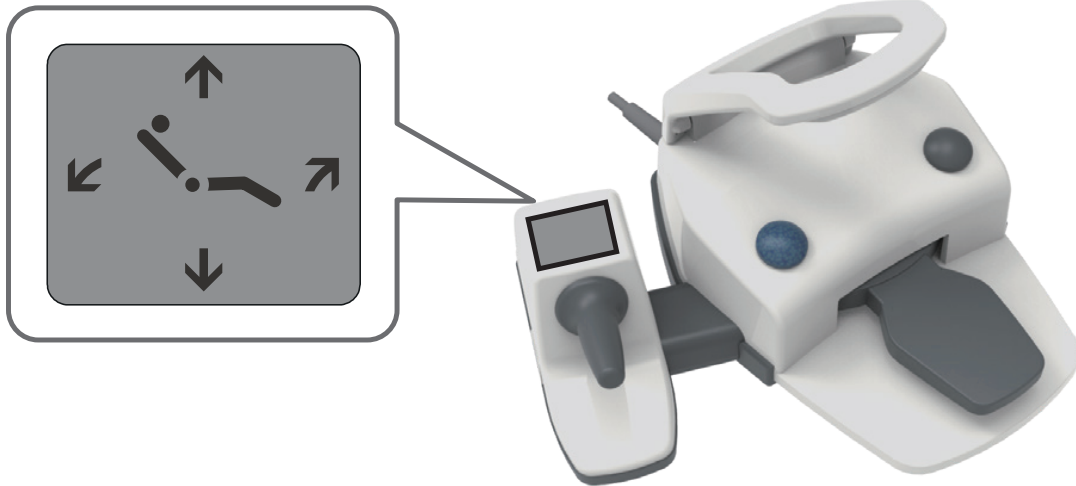

For the power headrest specification, the stick switch can be used to operate the headrest.

Contact your authorized Belmont dealer for any change of the settings.

When using the stick switch for the power headrest operation, attach the label below instead of the one above.

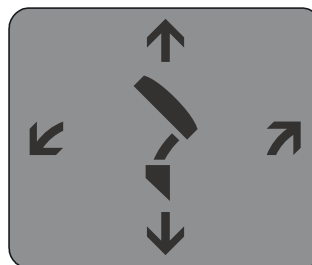

## 3 Installation

### 3-4 Attaching options

#### 3-4-1 Monitor bracket

Required length of power cable and signal cable (such as HDMI cable and D-sub cable) for the monitor.

3m is required from the monitor connection to the floor under the light pole.

Prepare the cord and cable with the above length plus the length from the floor under the light pole to the PC installation position.



1. Remove the cover of the hole on the light pole.

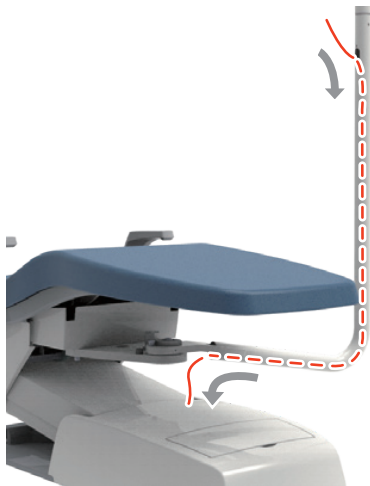

2. Pass the power cable and signal cables for the monitor through the light pole.

Then, power cable and signal cables must be passed through like figure.

#### WARNING

To avoid the current leakage, don't pass the power cable and signal cables for the monitor through the chair.

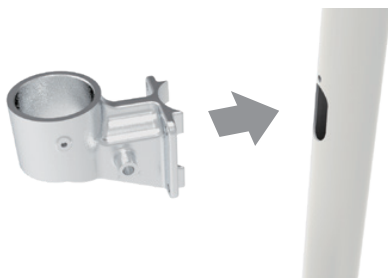

3. Stack the arm holder and the arm holder auxiliary bracket and insert them into the holes of the light pole.

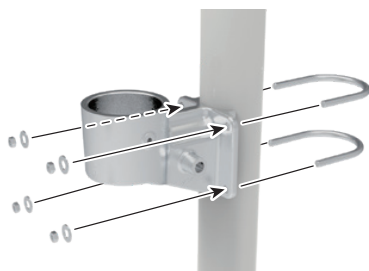

4. Fix the arm holder and the arm holder auxiliary bracket with the U-shaped metal fitting.

Fix it with flat washers, M6, plated (4 pieces) and hex nut, M6 (4 pieces)

### 3 Installation

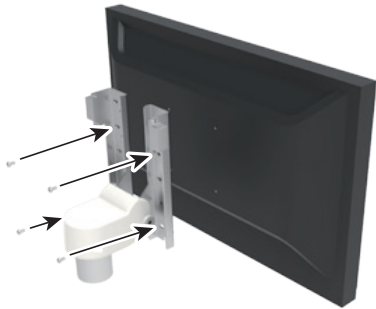

5. Attach the monitor rotating shaft to the monitor.

\*Use the screws that came with monitor.

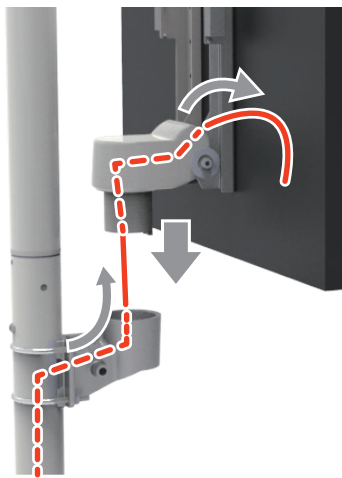

6. Pass the power cable and signal cables for the monitor through the monitor rotating shaft. Then, power cable and signal cables must be passed through like figure.

7. Insert the monitor rotating shaft to the monitor arm.

8. Connect the power cable and signal cables for the monitor with the monitor.



9. Engage the monitor cover with the catch of the monitor rotating shaft.

### 3 Installation

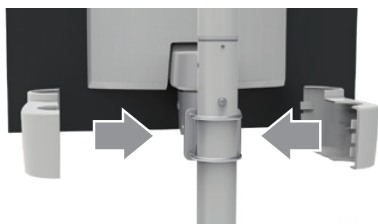

10. Attach the cover of the arm holder.



When removing the cover, press the ○ part and remove the inside hook.

## 3 Installation

### 3-4-2 Panorama-sized viewer/dental viewer

#### Base mount / Cart

1. Attach the viewer set to the doctor unit.

Insert the viewer set between the doctor table and table bracket from behind the doctor table, and fix it with the cap bolts 2P, M5 x 18, SUS (2 pieces).



2. Pass the lead cable for the panorama-sized viewer/dental viewer through the hole of the doctor unit.



3. Remove the cover.

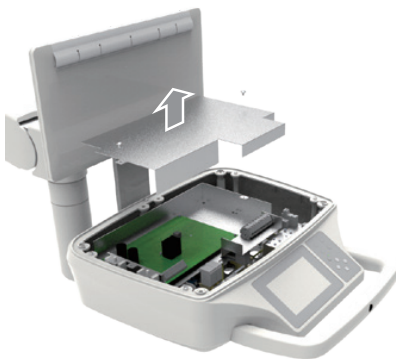

### 3 Installation

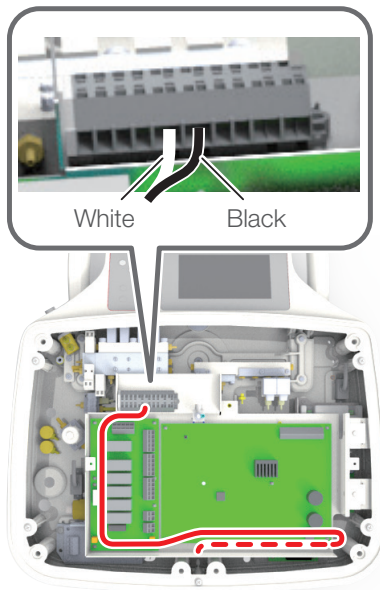

For panorama-size viewer:

4. Pass the lead cable of the panorama-size viewer as shown in the figure, and attach to the terminal block.
5. Attach cover reversing Procedure 3.

For dental viewer:

4. Attach the connector to the lead cable of dental viewer, and attach that connector to the connector located under the PCB board bracket.
5. Attach cover reversing Procedure 3.

### 3 Installation

#### Swing mount

1. Remove the pan head screw, M3 × 6, SUS, and remove the USB cap.

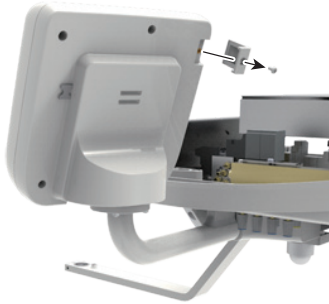

2. Remove the back cover of the operation panel.  
Remove the pan head screws, 2P, M3 × 8, SUS (4 pieces) to remove the cover.

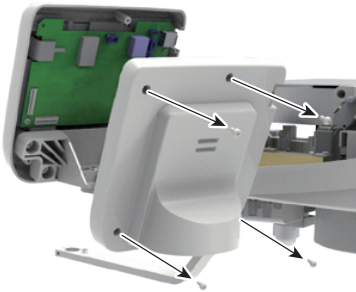

3. Detach the connector of speaker cable connected to PCB.

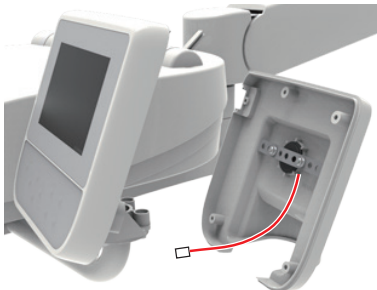

4. Remove the cap bolts, M4 × 16, SUS, and cap nuts (two for each).

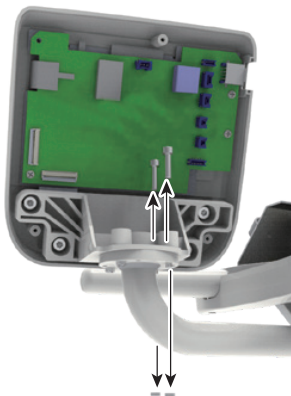



### 3 Installation

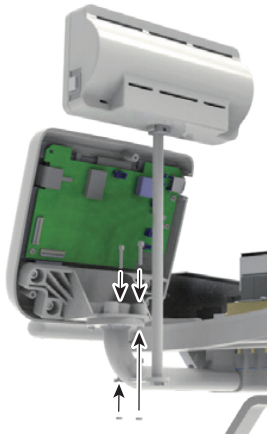

5. Attach the viewer set at the position of the bolts removed in Procedure 4.  
Use cap bolts, M4 × 20, SUS, and cap nuts removed in Procedure 3 (two for each).

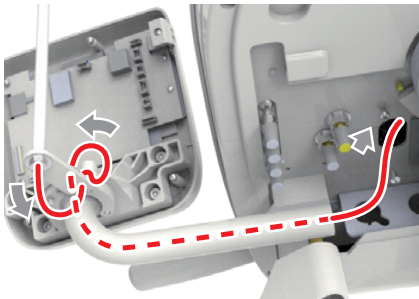

6. Pass the lead cable for the viewer as shown in the figure.

7. Attach the connector to the lead cable of dental viewer, and attach that connector to the connector located under the PCB board bracket.
8. Attach the connector of speaker cable in reversing Procedure 3.
9. Attach the back cover of the operation panel reversing Procedure 2.
10. Attach the USB cap reversing Procedure 1.

## 3 Installation

### 3-4-3 Intraoral camera bracket

When attaching to the doctor table  
For the delivery type : Holder

Fix the holder of Intraoral camera to the intraoral camera bracket.

#### For using IC Lercher L-CAM HD Shot

Fix the holder with countersunk screws, M3 × 5, plated (2 pieces).

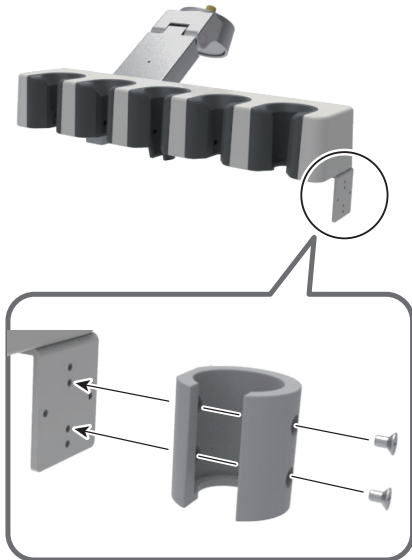

#### For using Sopro617/Soprocure

(1) Fix truss head screws, M3 x 8, SUS (2 pieces) and hex nuts, M3, SUS (2 pieces) to the intraoral camera bracket temporarily, the gap between head of truss screw and intraoral camera bracket is 3 mm.

(2) Pass the head of truss screws through the hole of holder to hang the holder.

(3) Fix the holder with hex nuts, M3, SUS (2 pieces) tighten.

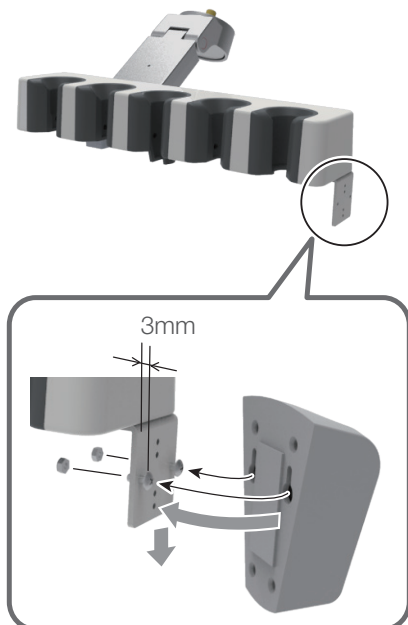

### 3 Installation

When attaching to the doctor table  
For the delivery type : Place holder

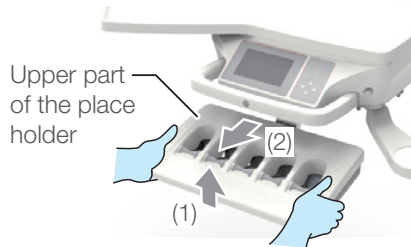

1. Remove the upper part of the place holder.
  - (1) Hold the upper part of the place holder with both hands and pull it upward slightly.
  - (2) Pull it toward you and remove it.

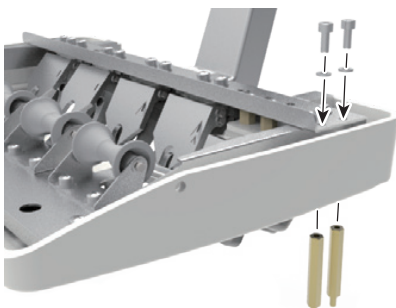

2. Attach the spacer to the place holder.

Fix the spacer with spring washers, M4, SUS (2 pieces) and cap bolts, M4 × 10, SUS (2 pieces).

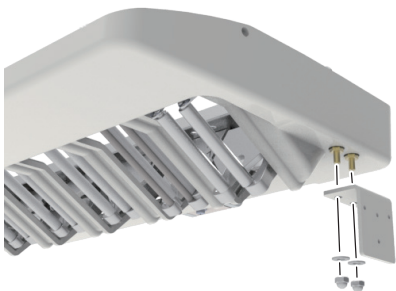

3. Attach the intraoral camera bracket to the place holder.

Fix the bracket with flat washers, M4 × 8 × 0.5, SUS (2 pieces) and cap nuts, M4, plated (2 pieces).

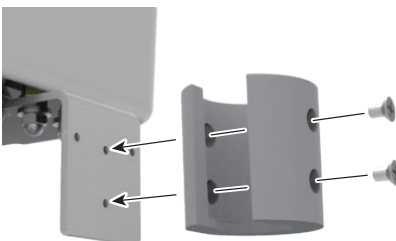

4. Fix the holder of Intraoral camera to the intraoral camera bracket.

For using IC Lercher L-CAM HD Shot  
Fix the holder with countersunk screws, M3 × 5, plated (2 pieces).

### 3 Installation

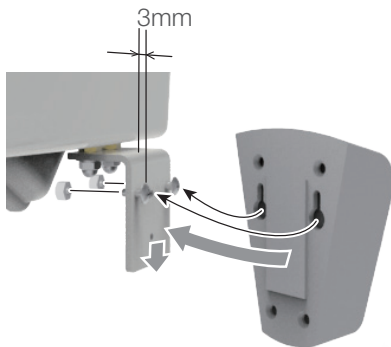

#### For using Sopro617/Soprocure

- (1) Fix truss head screws, M3 x 8, SUS (2 pieces) and hex nuts, M3, SUS (2 pieces) to the intraoral camera bracket temporarily, the gap between head of truss screw and intraoral camera bracket is 3 mm.
- (2) Pass the head of truss screws through the hole of holder to hang the holder.
- (3) Fix the holder with hex nuts, M3, SUS (2 pieces) tighten.



#### 5. Attach the upper part of the place holder.

Insert the upper part of the place holder to the original position from the upper side.

### 3 Installation

When attaching to the doctor table  
For the delivery type : Rod

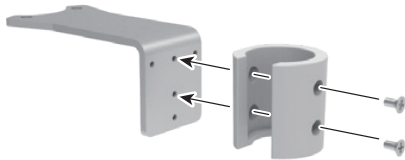

1. Fix the holder of Intraoral camera to the intraoral camera bracket.

#### For using IC Lercher L-CAM HD Shot

Fix the holder with countersunk screws, M3 × 5, plated (2 pieces).

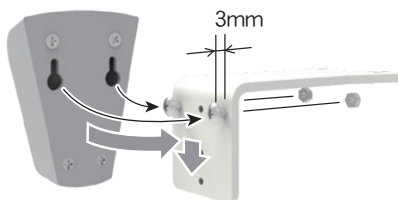

#### For using Sopro617/Soprocure

- (1) Fix truss head screws M3x8, SUS (2 pieces) and hex nuts M3, SUS (2 pieces) to the intraoral camera bracket temporarily, the gap between head of truss screw and intraoral camera bracket is 3 mm.
- (2) Pass the head of truss screws through the hole of holder to hang the holder.
- (3) Fix the holder with hex nuts M3, SUS (2 pieces) tighten.

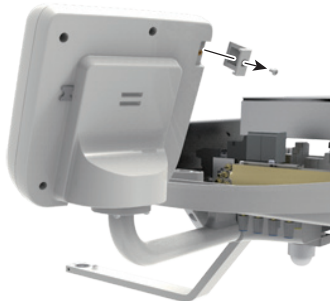

2. Remove the pan head screw, M3 × 6, SUS, and remove the USB cap.

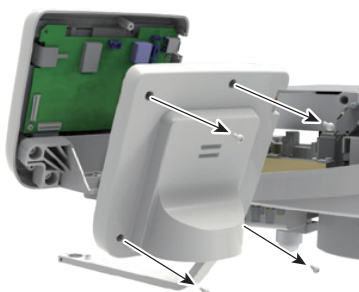

3. Remove the back cover of the operation panel.  
Remove the pan head screws, 2P, M3 × 8, SUS (4 pieces) to remove the cover.

### 3 Installation

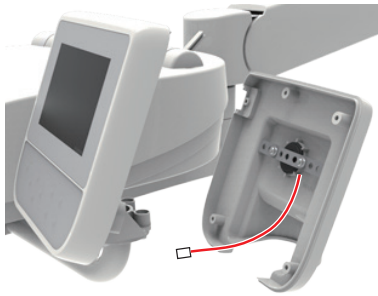

4. Detach the connector of speaker cable connected to PCB.

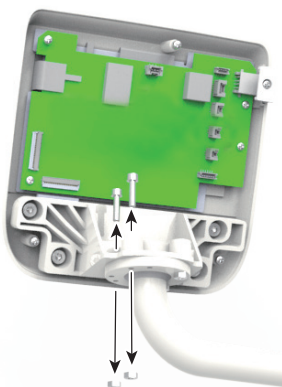

5. Remove the cap bolts, M4 × 16, SUS, and cap nuts (two for each).

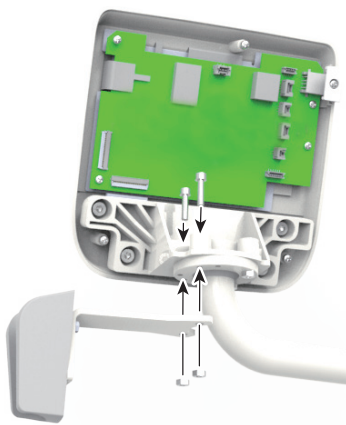

6. Attach the intraoral camera bracket at the position of the bolts removed in Procedure 5.  
Use cap bolts, M4 × 20, SUS, and cap nuts removed in Procedure 5 (two for each).

7. Attach the connector of speaker cable in reversing Procedure 4.

8. Attach the back cover of the operation panel reversing Procedure 3.

9. Attach the USB cap reversing Procedure 2.

### 3 Installation

When attaching to the assistant holder  
(Cuspidor unit only)

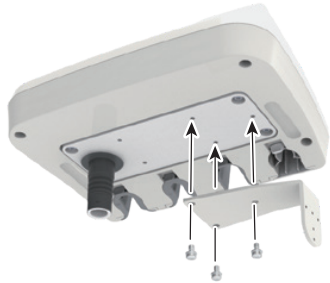

1. Attach the intraoral camera bracket to the assistant unit.

Fix the bracket with pan head screws, 3P, M5 × 10, SUS (3 pieces).



2. Fix the holder of Intraoral camera to the intraoral camera bracket.

#### For using IC Lercher L-CAM HD Shot

Fix the holder with countersunk screws, M3 × 5, plated (2 pieces).

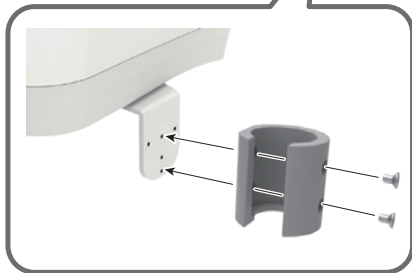

#### For using Sopro617/Soprocure

- (1) Fix truss head screws, M3 x 8, SUS (2 pieces) and hex nuts, M3, SUS (2 pieces) to the intraoral camera bracket temporarily, the gap between head of truss screw and intraoral camera bracket is 3 mm.

- (2) Pass the head of truss screws through the hole of holder to hang the holder.

- (3) Fix the holder with hex nuts, M3, SUS (2 pieces) tighten.

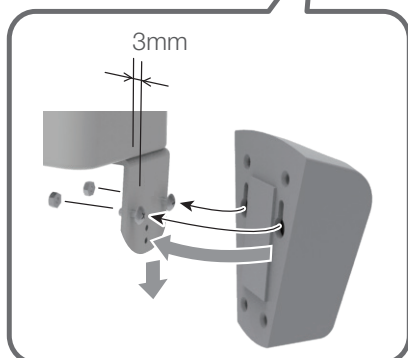

## 4 Flow Diagram / Wiring Diagram

### 4-1 Flow Diagram

Cuspidor unit type

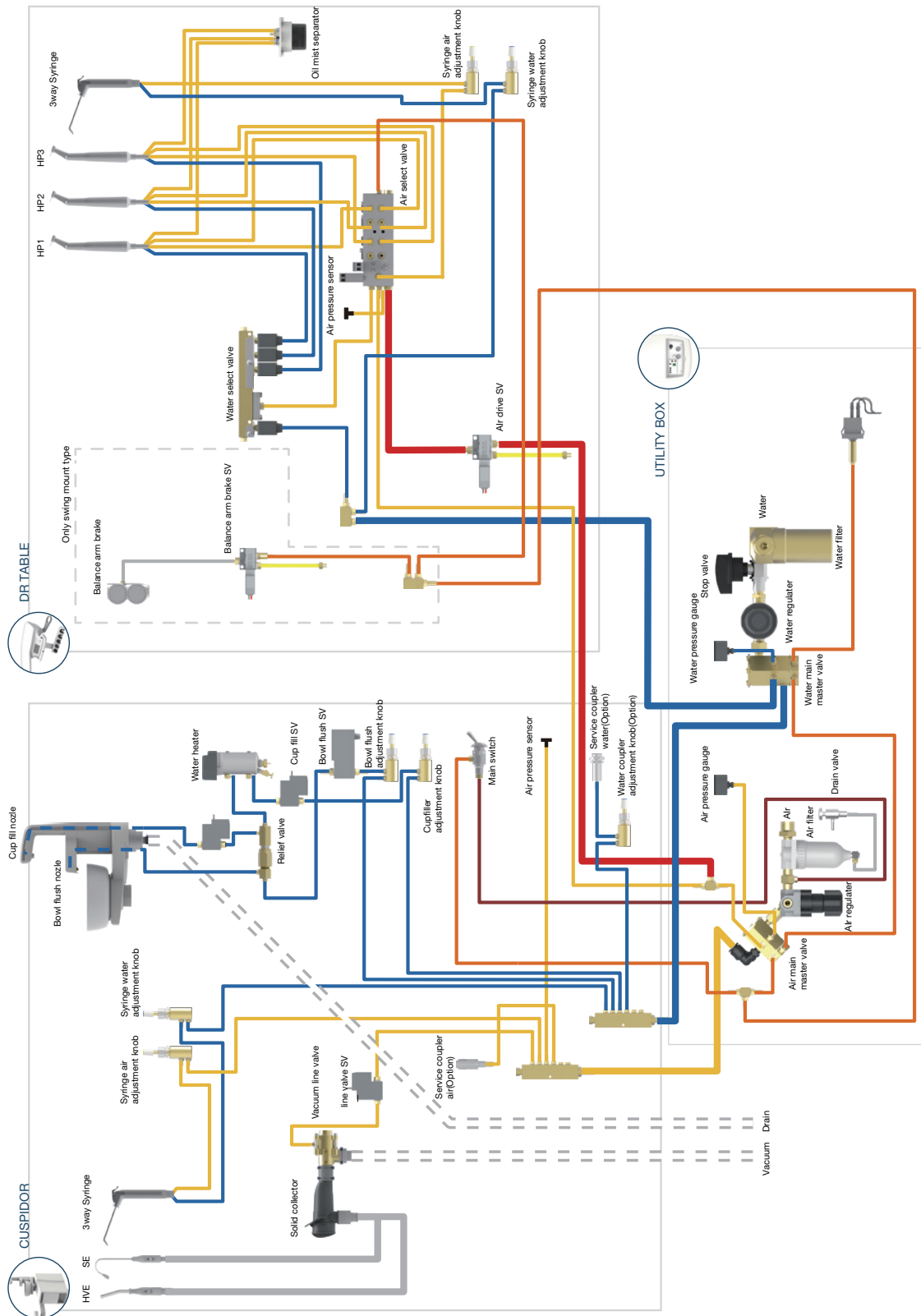



## 4 Flow Diagram / Wiring Diagram

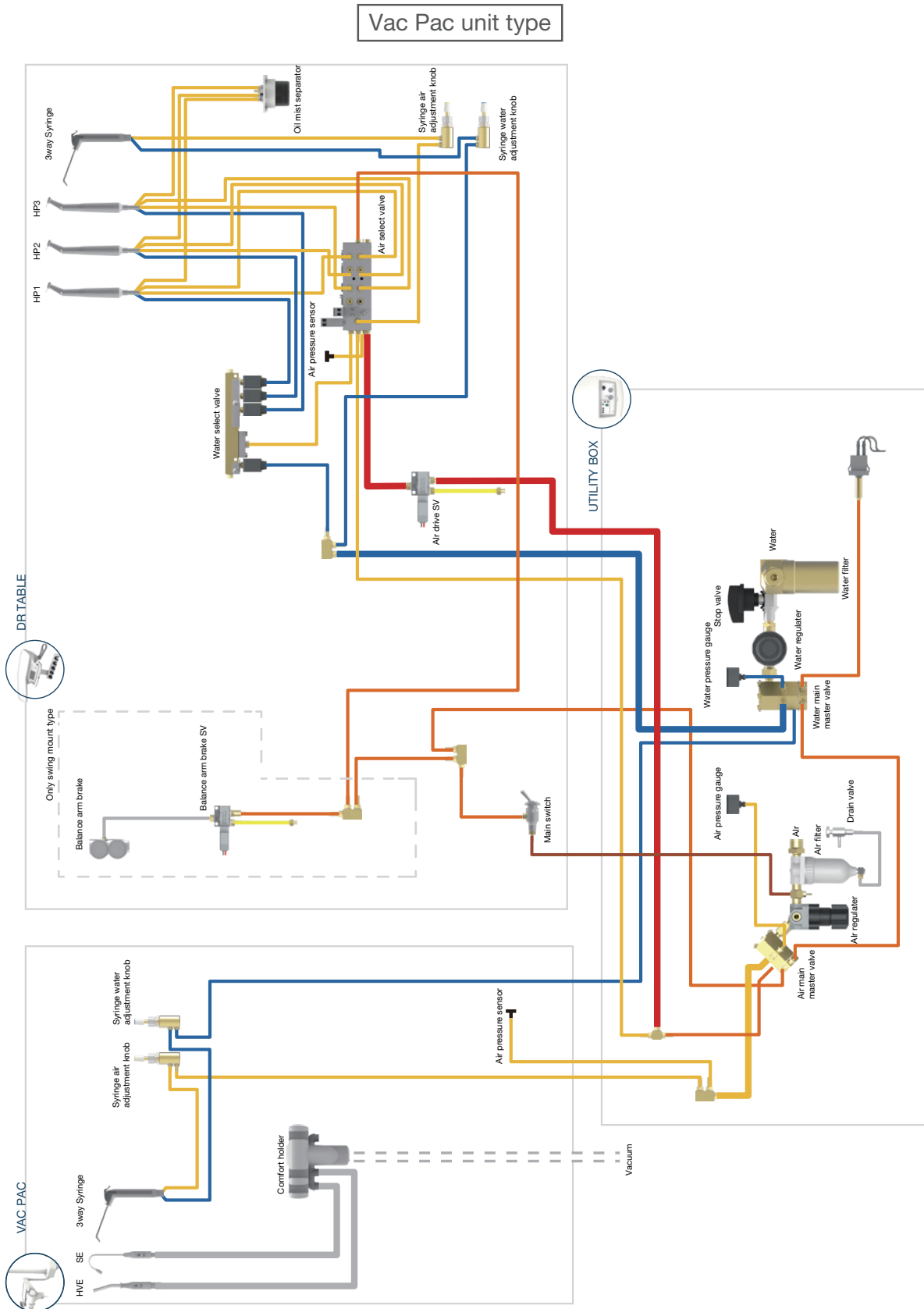

## 4 Flow Diagram / Wiring Diagram

### 4-2 Wiring Diagram

Cuspidor unit type

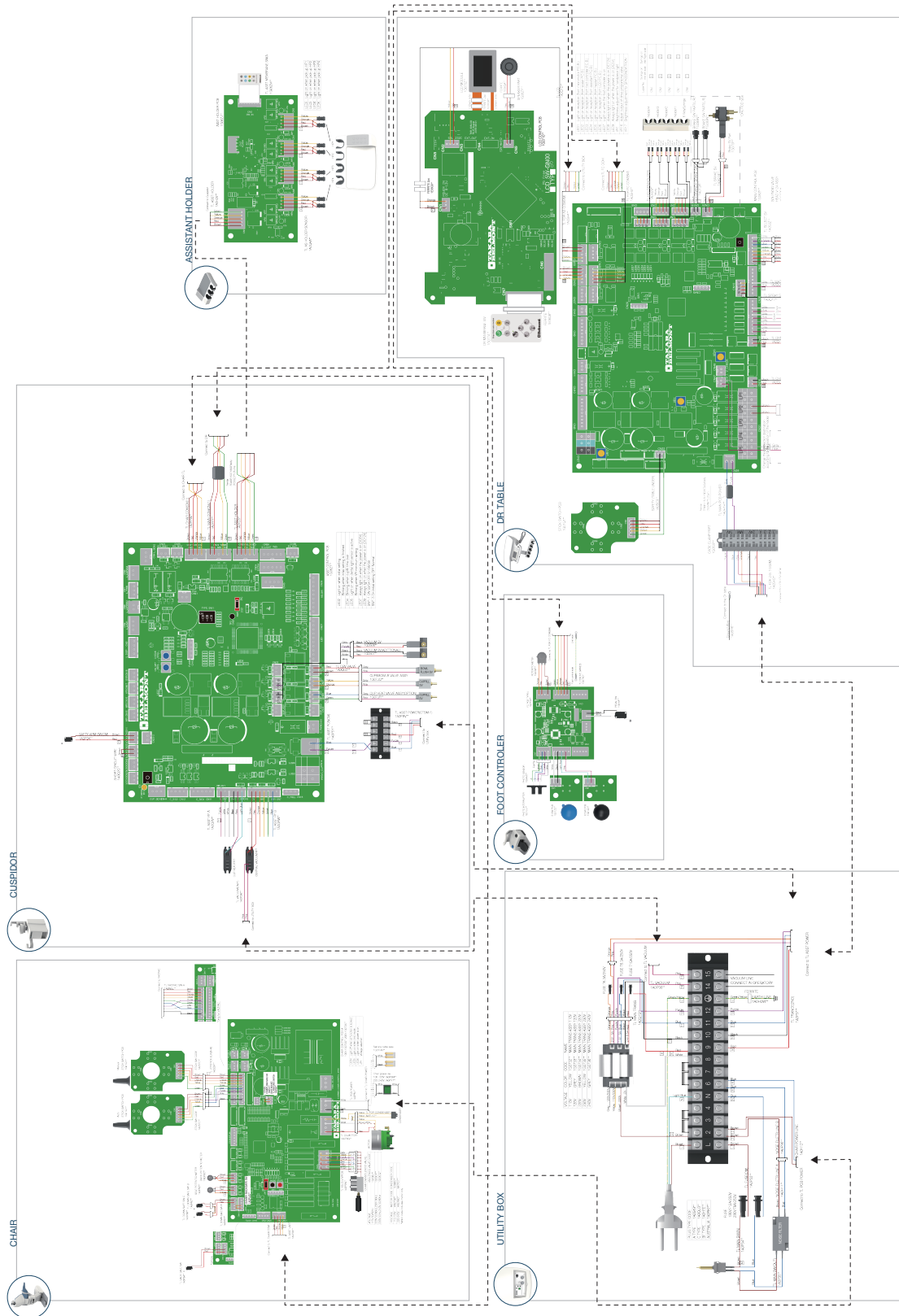

## 4 Flow Diagram / Wiring Diagram

Vac Pac unit type

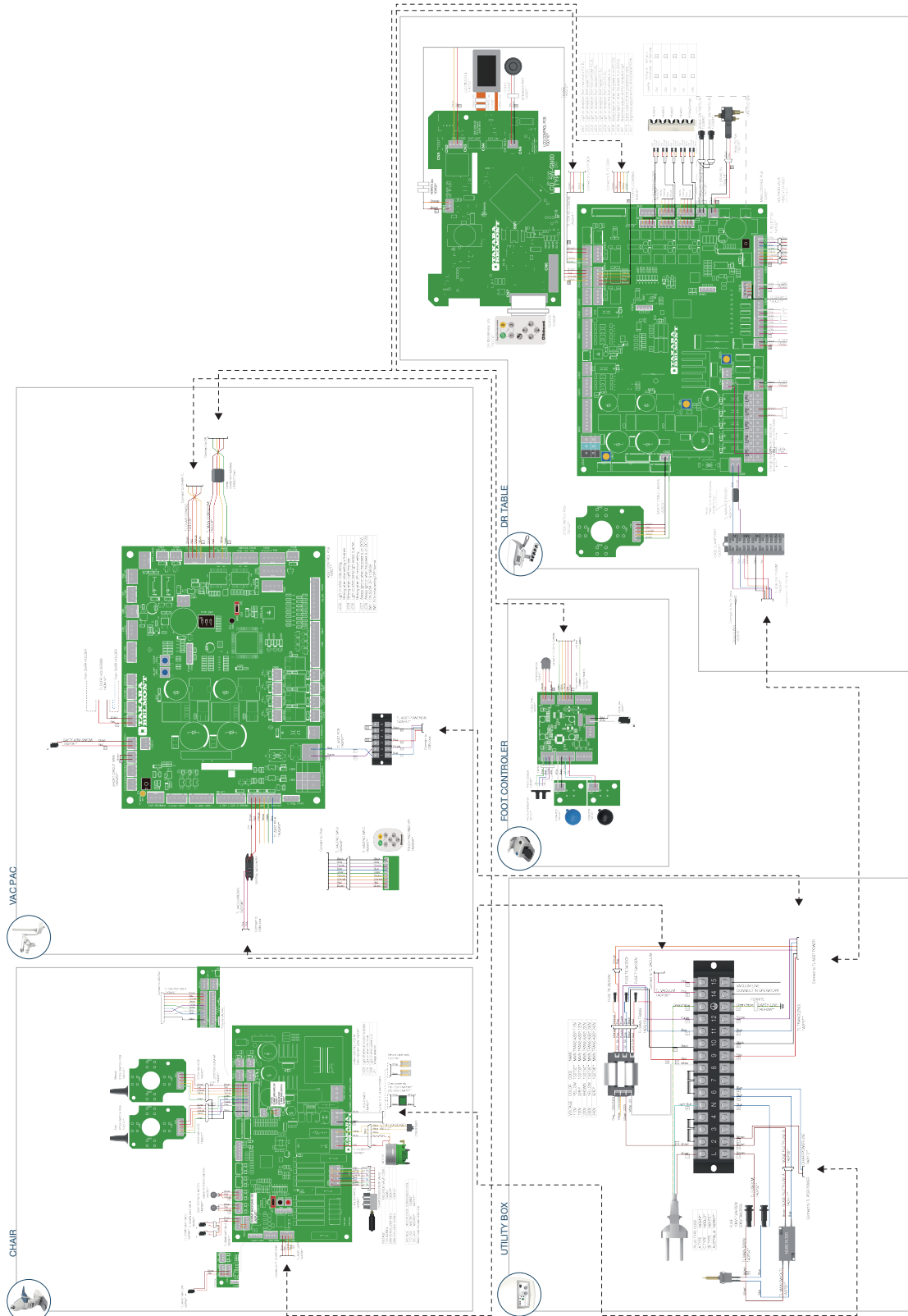

## NOTE

## NOTE

2022-09 (7th edition)	
REF	1E08BVGE



TAKARA BELMONT CORPORATION

2-1-1, Higashishinsaibashi, Chuo-ku, Osaka, 542-0083, Japan

TEL : +81-6-6213-5945

FAX : +81-6-6212-3680

